

**THE CORPORATION OF THE CITY OF PETERBOROUGH**

**BY-LAW NUMBER 08-156**

**BEING A BY-LAW TO AMEND THE ZONING BY-LAW FOR 240 WALLIS DRIVE**

THE CORPORATION OF THE CITY OF PETERBOROUGH BY THE COUNCIL THEREOF  
ENACTS AS FOLLOWS:

1. Map 10 forming part of Schedule 'A' to By-law 97-123 is amended by changing the area shown on the sketch attached hereto as Schedule 'A' from R.1,1f,2e,8b,10d,13f, Residential to R.1,1g,2g,8b,10d,13f, Residential and to R.1,1g,2e,4j,8b,10d,13f, Residential.

By-law read a first, second and third time this 6th day of October, 2008.

(Sgd.) Henry Clarke, Deputy Mayor

(Sgd.) Leigh Doughty, Deputy Clerk

Dimensions are in metric

SCHEDULE 'A' TO  
BYLAW 2008 - 156  
PASSED THE 6<sup>th</sup> DAY  
OF October 2008  
MAYOR  
CLERK

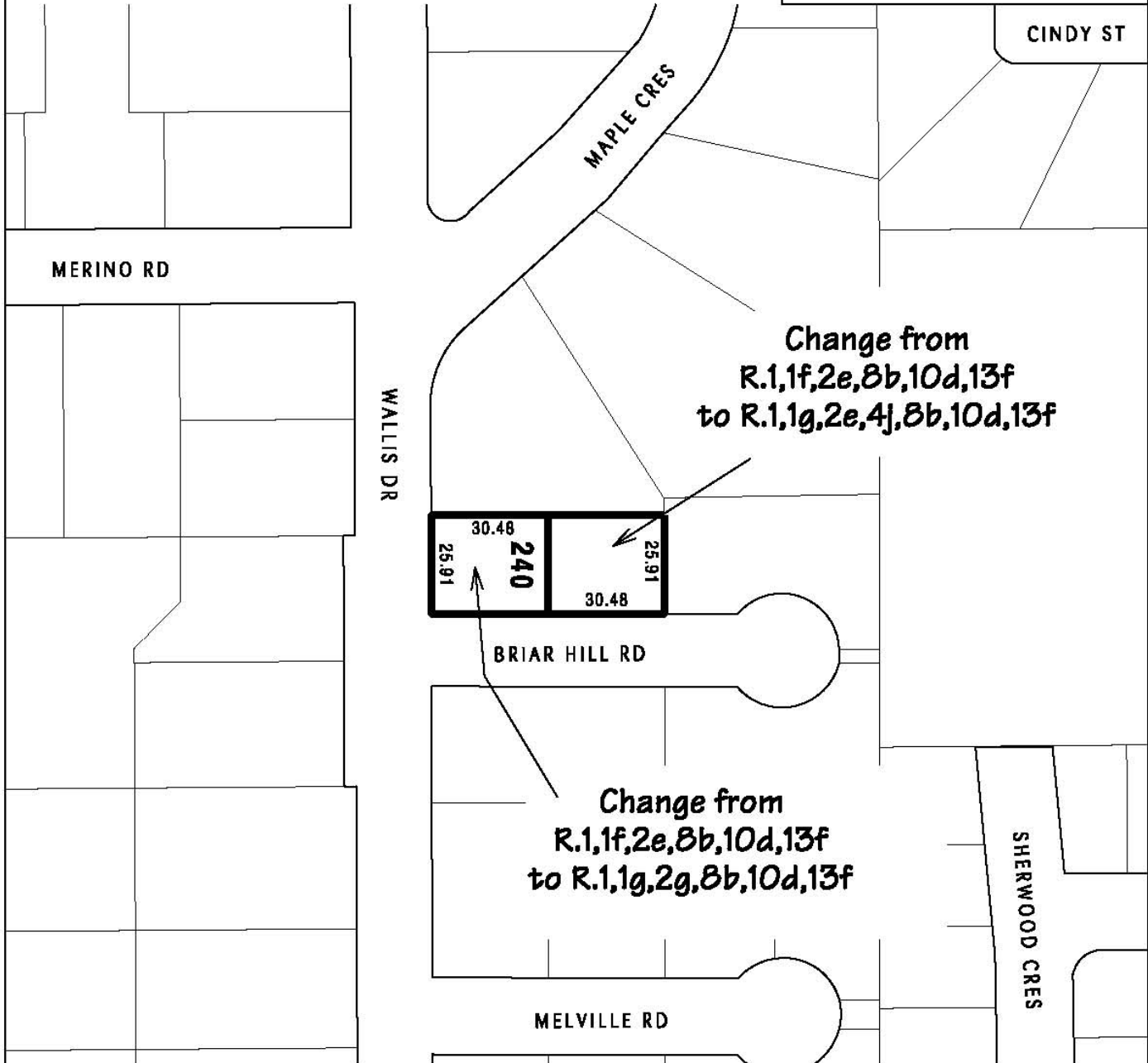

City of  
**Peterborough**

The "City of Peterborough," its employees, or agents, do not undertake to guarantee the validity of the contents of this digital or hardcopy mapfile, and will not be liable for any claims for damages or loss arising from their application or interpretation, by any party. It is not intended to replace a survey or to be used for legal description.

File: z0706

Scale: 1:1500