

THE CORPORATION OF THE CITY OF PETERBOROUGH

BY-LAW NUMBER 08-153

**BEING A BY-LAW TO AMEND THE ZONING BY-LAW FOR PART OF THE PROPERTIES AT 2300 MARSDALE DRIVE AND 2150 TELEVISION ROAD (EXTENSION OF MARSDALE DRIVE AND FOXMEADOW ROAD)**

THE CORPORATION OF THE CITY OF PETERBOROUGH BY THE COUNCIL THEREOF HEREBY ENACTS AS FOLLOWS:

1. **Map 19** forming part of Schedule 'A' to By-law 97-123 is amended by changing the area shown on the sketch attached hereto as Schedule 'A' **from A.1 to R.1-“H”**; **R.2-“H”**, **R.2**, **4h-“H”**, **D.1** and **OS.1**; **from HL to R.1-“H”**, **R.2-“H”** and **OS.1**; and **from M to D.1** and **OS.1**.
2. The “H” – Holding Symbol will be removed upon registration of the Plan of Subdivision in the Land Registry Office.

By-law read a first, second and third time this 15th day of September, 2008

(Sgd.) D. Paul Ayotte, Mayor

(Sgd.) Nancy Wright-Laking, City Clerk

SCHEDULE 'A' TO  
 BYLAW 2008 -153  
 PASSED THE 15<sup>th</sup> DAY  
 OF SEPTEMBER 2008  
 MAYOR  
 CLERK

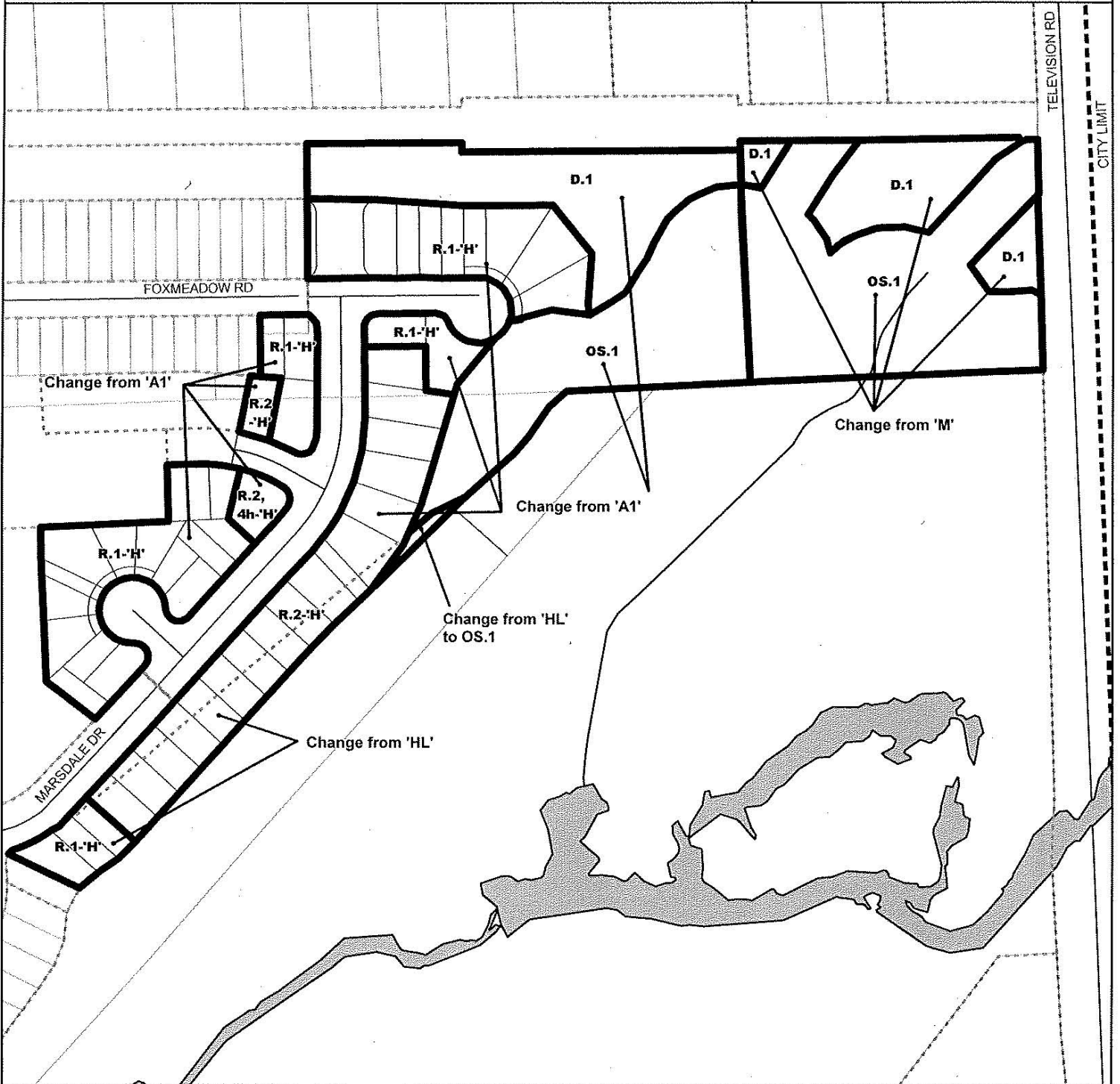

City of  
**Peterborough**

DISCLAIMER and LIMITATIONS OF LIABILITIES The "City of Peterborough" its employees, or agents, do not undertake to guarantee the validity of the contents of this digital or hardcopy mapfile, and will not be liable for any claims for damages or loss arising from their application or interpretation, by any party. It is not intended to replace a survey or to be used for legal description.

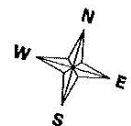

Scale 1:3,000

File: Z0803SB / O0802 / 15T-08501