

**THE CORPORATION OF THE CITY OF PETERBOROUGH**

**BY-LAW NUMBER 06-057**

(Amended by OMB Order No. 1064)

**BEING A BY-LAW TO AMEND THE ZONING BY-LAW FOR 1000, 1040  
AND 1060 CRAWFORD DRIVE (COSTCO WHOLESALE  
MEMBERSHIP CLUB)**

**THE CORPORATION OF THE CITY OF PETERBOROUGH BY THE COUNCIL  
THEREOF ENACTS AS FOLLOWS:**

1. Section 3.9.170 of By-law 97-123 is hereby deleted and replaced with the following:  
  
'.170 In addition, this land may be used as a warehouse membership club with a gross leasable area of 13,800 sq. m. (148,547 sq. ft.) and an accessory gas bar. Ground buildings or structures shall be constructed or installed above the finished surface flood elevation of 191.79 metres, Canadian Geodetic Datum. Transportation, paved parking, landscaping, light standards, cart corrals, roads, pedestrian access and egress, sidewalks, above-ground transformers, directional signage, and any underground and above-ground utilities and stormwater management accessory infrastructure and similar type use are permitted to be constructed below this elevation.'
2. Section 3.9 of By-law 97-123 is hereby further amended by adding the following Exception .227:  
  
.227 Notwithstanding the provisions of Section 24 a driveway connecting Crawford Drive to the parking area to the north, is permitted within the floodplain (area below the flood elevation of 191.79 metres).
3. Section 4.2 (B) 13) is hereby further amended by reducing the Minimum Parking Requirement for Warehouse Membership Club in Area 2 and Area 3 from 1/18 square metres of building floor area to "1/20 square metres of building floor area".
4. **Map 21** forming part of Schedule 'A' to By-law 97-123 is amended by changing the area shown on the sketch attached hereto as Schedule 'A' from **M3.2 to M3.2 – 170 and from M1.2 to M1.2 – 170 and from M1.2 to OS.1 – 227.**

By-law read a first, second and third time this 10th day of April, 2006.

---

Sylvia Sutherland (Mayor)

---

Nancy Wright-Laking (Clerk)

Dimensions are in metric

SCHEDULE 'A' TO  
BYLAW 2008-057  
PASSED THE 10 DAY  
OF April, 2008

MAYOR *D. DeLaney*  
CLERK *Tracy [Signature]*

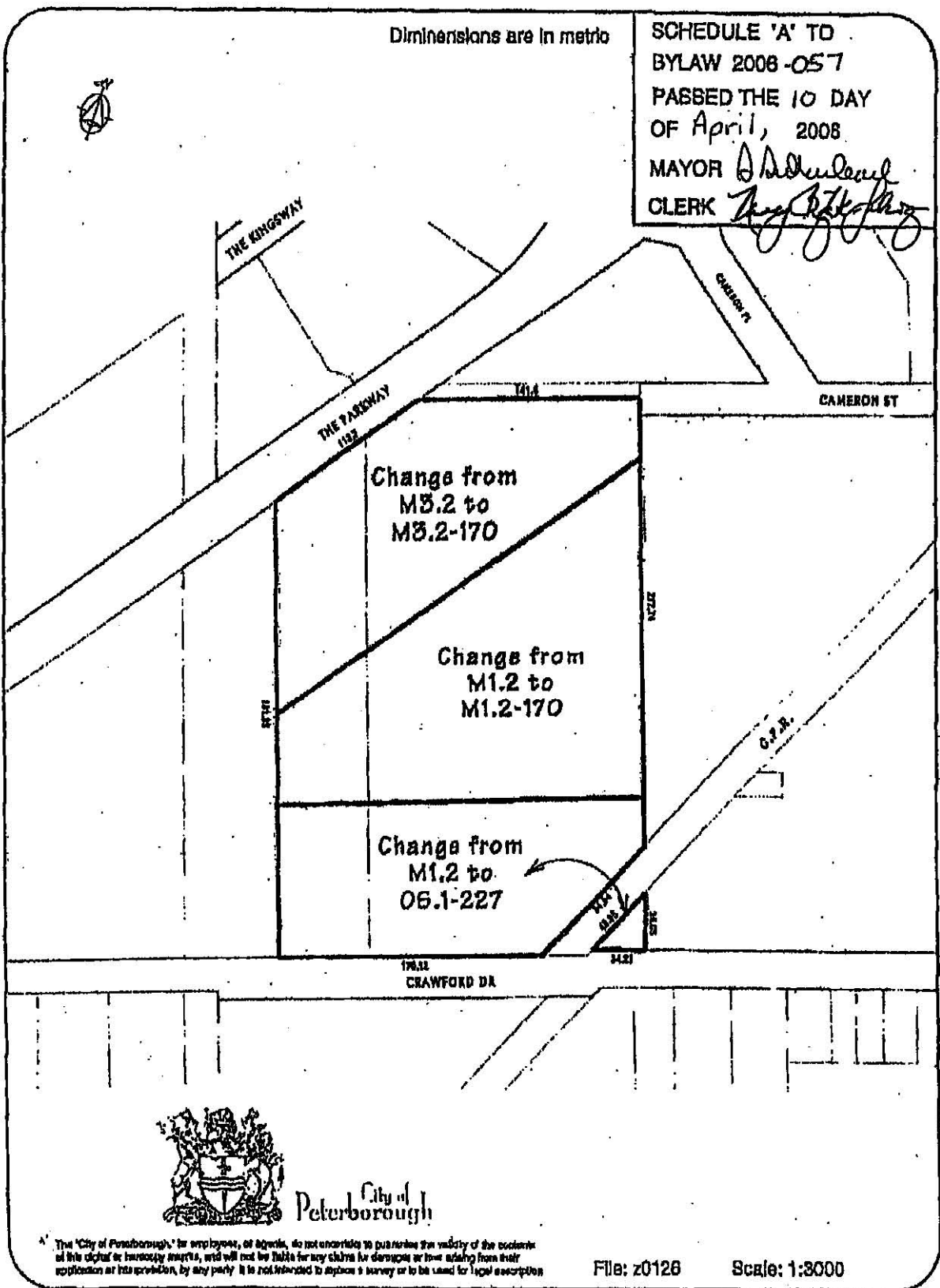

City of  
Peterborough

The 'City of Peterborough' or employees, or agents, do not undertake to guarantee the validity of the contents of this report or survey or maps, and will not be liable for any claims for damages or loss arising from their application or use provided, by any party. It is not intended to replace a survey or to be used for legal description.

File: z0126

Scale: 1:3000