

THE CORPORATION OF THE CITY OF PETERBOROUGH

BY-LAW NUMBER 06-046

BEING A BY-LAW TO REMOVE A HOLDING SYMBOL FROM THE ZONING BY-LAW FOR LANDS LOCATED NORTH OF MANIECE AVENUE AND WEST OF TELEVISION ROAD (590 MANIECE)

WHEREAS pursuant to Section 36 of the Planning Act, R.S.O. 1990, c.p.13, a Holding Symbol was applied to the above lands by Zoning By-law 05-270

AND WHEREAS, in the opinion of Council, the condition for the removal of the Holding Symbol has been satisfied by site plan approval;

NOW THEREFORE THE CORPORATION OF THE CITY OF PETERBOROUGH BY THE COUNCIL THEREOF ENACTS AS FOLLOWS:

1. **Map 14** forming part of Schedule 'A' to By-law 97-123 is amended by changing the area shown on the sketch attached hereto as Schedule 'A' **from SP.31 – 225 – "H", to SP.31 – 225.**

By-law read a first, second and third time this 20th day of March, 2006

(Sgd.) Sylvia Sutherland, Mayor

(Sgd.) Nancy Wright-Laking, Clerk



Dimensions are in metric

SCHEDULE 'A' TO
BYLAW 2006 -
PASSED THE DAY
OF 2006
MAYOR
CLERK

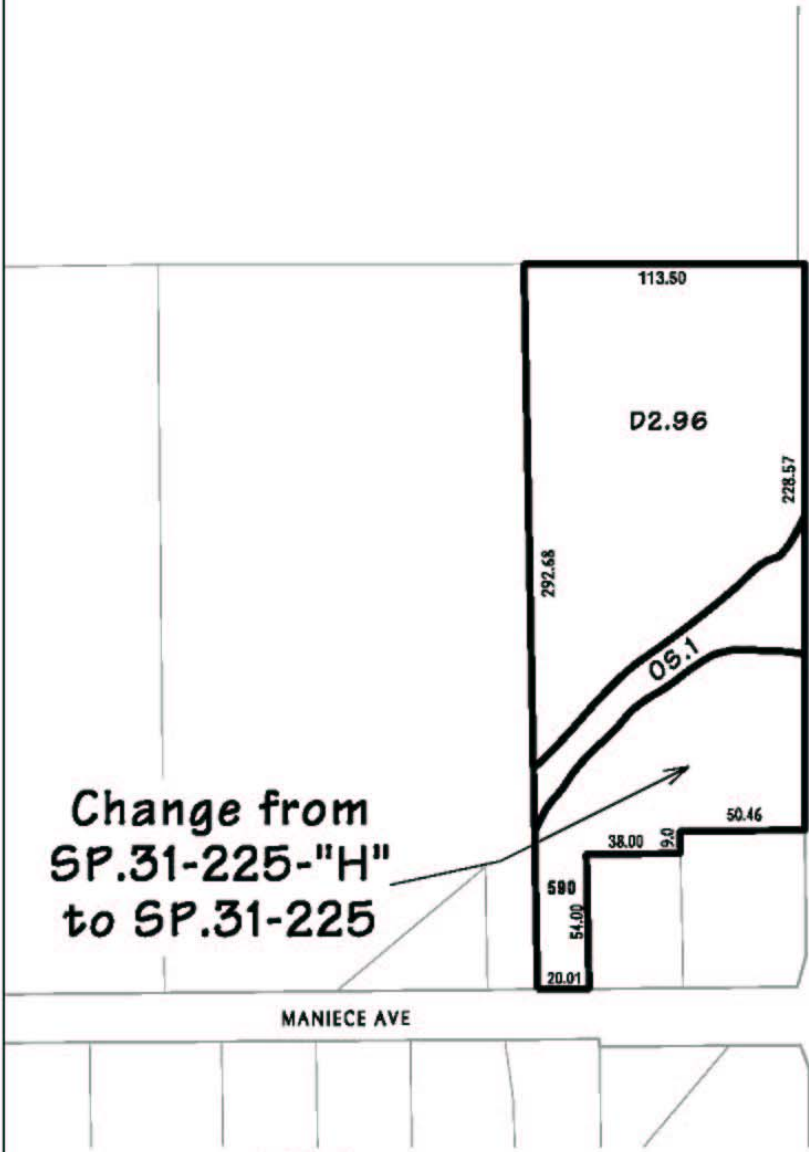

Change from
SP.31-225-"H"
to SP.31-225

MANIECE AVE

TELEVISION RD

City Limit



City of
Peterborough

The "City of Peterborough," its employees, or agents, do not undertake to guarantee the validity of the contents of this digital or hardcopy mapfile, and will not be liable for any claims for damages or loss arising from their application or interpretation, by any party. It is not intended to replace a survey or to be used for legal description.

File: z0525

Scale: 1:2500