

THE CORPORATION OF THE CITY OF PETERBOROUGH

BY-LAW NUMBER 06-012

BEING A BY-LAW TO AMEND THE ZONING BY-LAW FOR
15 CLUXTON STREET

THE CORPORATION OF THE CITY OF PETERBOROUGH BY THE COUNCIL
THEREOF HEREBY ENACTS AS FOLLOWS:

1. Section 3.9 Exceptions of By-law 97-123 is hereby amended by adding the following:

Exception Number	<u>Provisions</u>
“.226	Notwithstanding the provisions of Section 8 the following provisions shall apply: i) the maximum lot coverage by open parking areas, driveways; and vehicle movement areas is 30%; ii) the minimum building setback from the rear lot line is 7m; and iii) in addition, this land may be used as a three unit dwelling.

2. **Map 7** forming part of Schedule 'A' to By-law 97-123 is amended by changing the area shown on the sketch attached hereto as Schedule 'A' **from R.2 – Residential District to R.2 - 226 – Residential District.**

By-law read a first, second and third time this 6th day of February, 2006

(Sgd.) Sylvia Sutherland, Mayor

(Sgd.) Nancy Wright-Laking, Clerk

Diminensions are in metric

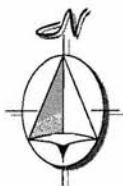

SCHEDULE 'A' TO
BYLAW 2006 -
PASSED THE DAY
OF 2006
MAYOR
CLERK

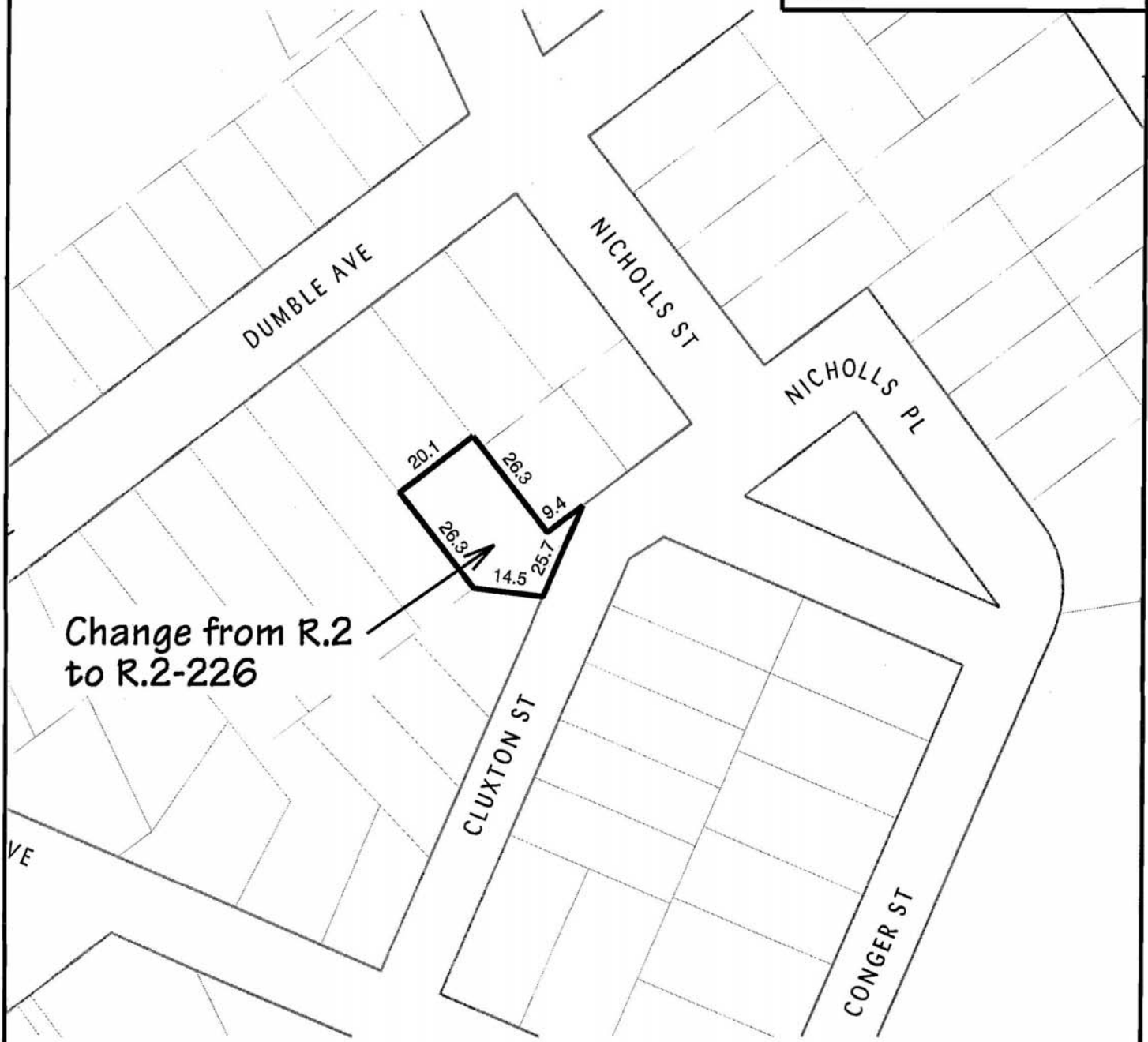

City of
Peterborough

The "City of Peterborough," its employees, or agents, do not undertake to guarantee the validity of the contents of this digital or hardcopy mapfile, and will not be liable for any claims for damages or loss arising from their application or interpretation, by any party. It is not intended to replace a survey or to be used for legal description.

File: z0527

Scale: 1:1250