

THE CORPORATION OF THE CITY OF PETERBOROUGH

BY-LAW NUMBER 05-270

BEING A BY-LAW TO AMEND THE ZONING BY-LAW FOR
590 MANIECE AVENUE

THE CORPORATION OF THE CITY OF PETERBOROUGH BY THE COUNCIL
THEREOF HEREBY ENACTS AS FOLLOWS:

1. Section 3.9 Exceptions of By-law 97-123 is hereby amended by adding the following:

<u>Exception Number</u>	<u>Provisions</u>
"225	Notwithstanding any other provision, a minimum 3m landscaped buffer consisting of a 2m high privacy fence and vegetative planting, be provided adjacent to the mutual property line between the subject land and the rear lot line of the properties known as 594 and 600 Maniece Ave."

2. **Map 14** forming part of Schedule 'A' to By-law 97-123 is amended by changing the area shown on the sketch attached hereto as Schedule 'A' **from R1(Otonabee) and I(Otonabee) to SP.31 – 225 – "H", OS.1 and D2.96.**

3. The "H" - Holding Symbol shall be removed upon the dedication to the City of Peterborough, of a road widening and 0.3m reserve along the entire frontage of Television Road.

By-law read a first, second and third time this 5th day of December, 2005

(Sgd.) Sylvia Sutherland, Mayor

(Sgd.) Nancy Wright-Laking, City Clerk

Diminensions are in metric



Change from
R1 and I (Otonabee)
to designations
shown below

SCHEDULE 'A' TO
BYLAW 2005 -
PASSED THE DAY
OF 2005
MAYOR
CLERK

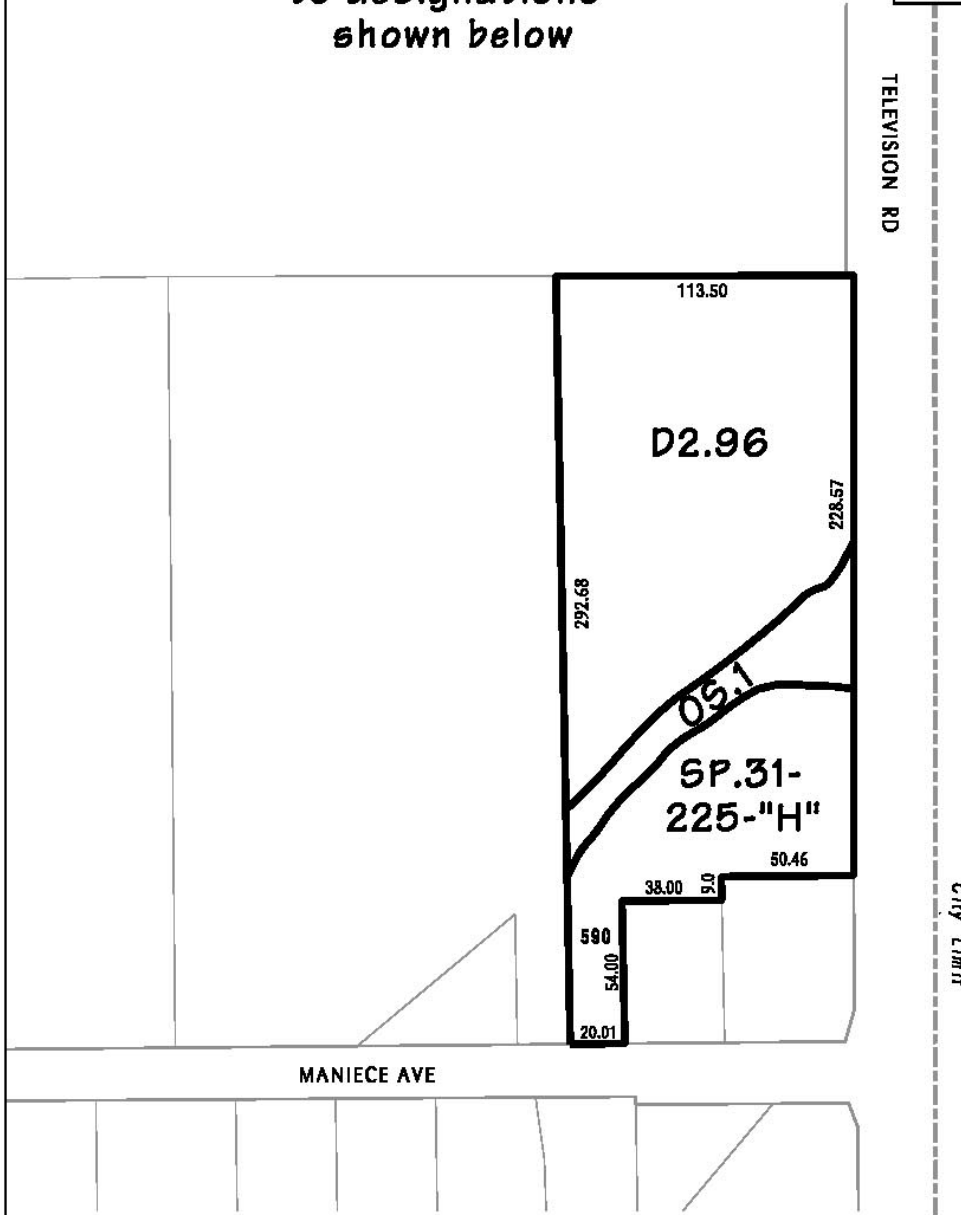

The "City of Peterborough," its employees, or agents, do not undertake to guarantee the validity of the contents of this digital or hardcopy mapfile, and will not be liable for any claims for damages or loss arising from their application or interpretation, by any party. It is not intended to replace a survey or to be used for legal description.

File: z0525

Scale: 1:2500