

THE CORPORATION OF THE CITY OF PETERBOROUGH

BY-LAW NUMBER 02-160

**BEING A BY-LAW TO AMEND THE ZONING BY-LAW
FOR 900 LANSDOWNE STREET WEST**

**THE CORPORATION OF THE CITY OF PETERBOROUGH BY THE
COUNCIL THEREOF ENACTS AS FOLLOWS:**

1. Section 3.9 Exceptions of By-law 97-123 is hereby amended by adding the following:

Exception Number

Provisions

“192

Notwithstanding the provisions of Section 291.3 (d), the minimum building setback along the west side lot line shall be 3 metres;

Notwithstanding the provisions of Section 291.3 (h) (i), the minimum width of landscaped open space along the north side lot line shall be 3 metres.”

2. **Map 16** forming part of Schedule 'A' to By-law 97-123 is amended by changing the area shown on the sketch attached hereto as Schedule 'A' from **SP. 193** to **SP. 261-192”**.

By-law read a first and second time this 18th day of November, 2002.

By-law read a third time and finally passed this 18th day of November, 2002.

(Sgd.) Sylvia Sutherland, Mayor

(Sgd.) Nancy Wright-Laking, City Clerk

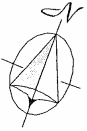

Dimensions are in metric

SCHEDULE 'A' TO
BYLAW 2002 - 160
PASSED THE 18 DAY
OF November, 2002

MAYOR *[Signature]*
CLERK *[Signature]*

Change from
SP.193 to
SP.261-192

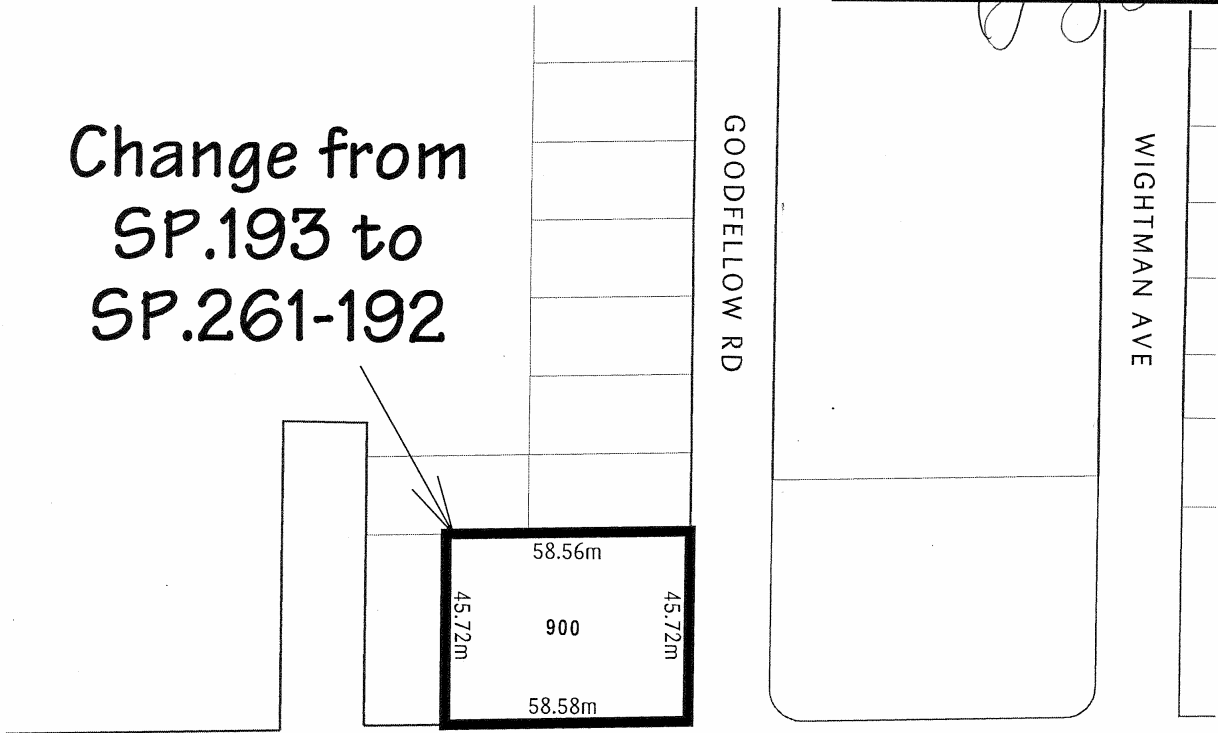

LANSDOWNE ST W

City of
Peterborough

The "City of Peterborough," its employees, or agents, do not undertake to guarantee the validity of the contents of this digital or hardcopy mapfile, and will not be liable for any claims for damages or loss arising from their application or interpretation, by any party. It is not intended to replace a survey or to be used for legal description.

File: z0214

Scale: 1: 1500