

THE CORPORATION OF THE CITY OF PETERBOROUGH

BY-LAW NUMBER 01-022

BEING A BY-LAW TO ADOPT AMENDMENT NO. 113 TO
THE OFFICIAL PLAN OF THE CITY OF PETERBOROUGH
PART OF 1340 BREALEY DRIVE

THE CORPORATION OF THE CITY OF PETERBOROUGH BY THE COUNCIL
THEREOF ENACTS AS FOLLOWS:

1. **Schedule 'A'** - Land Use of the Official Plan of the City of Peterborough is amended in accordance with the **Schedule 'A'** attached hereto. The area indicated thereon is changed from "**Agriculture**" to "**Residential**".
2. **Schedule 'B'** - Major Transportation Plan of the Official Plan of the City of Peterborough is amended in accordance with **Schedule 'B'** attached hereto by adding "**Collector Street**".
3. **Table 1 - Maximum Dwelling Unit Target for Low Density Units in Secondary Plan No. 9 - Jackson Creeks** is changed from 1100 to 1200.

By-law read a first and second time this 12th day of February, 2001

By-law read a third time and finally passed this 12th day of February, 2001

(Sgd.) Sylvia Sutherland, Mayor

(Sgd.) Steven Brickell, City Clerk

Official Plan Amendment to Schedule - A Land Use

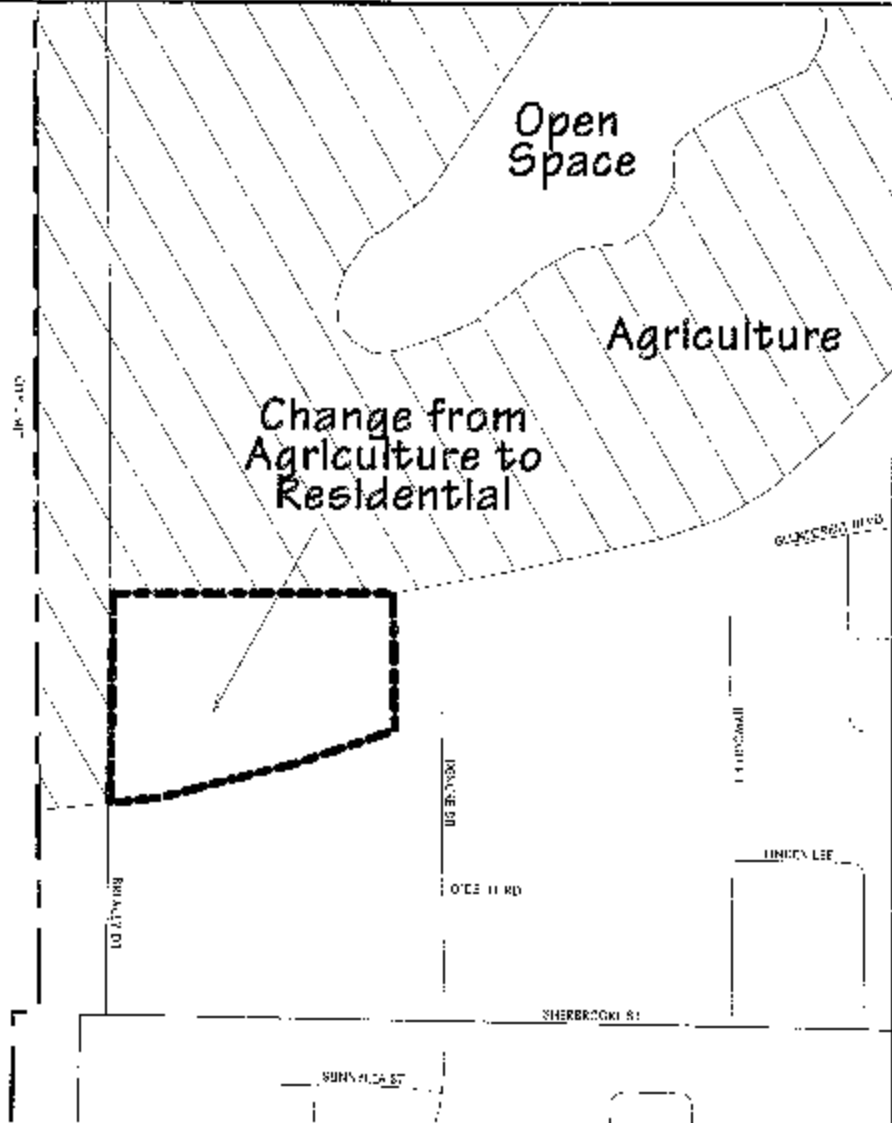

City of
Peterborough