

**THE CORPORATION OF THE CITY OF PETERBOROUGH  
BY-LAW NUMBER 00-114**

**A BY-LAW TO AMEND THE ZONING BY-LAW  
97-123 OF THE CITY OF PETERBOROUGH**

**THE CORPORATION OF THE CITY OF PETERBOROUGH BY THE COUNCIL THEREOF ENACTS AS FOLLOWS:**

**By-law 97-123 is hereby amended as follows:**

- 1. Section 1, (DEFINITIONS) is hereby amended by adding the following definitions:**

**“CONSERVATION AREA** means an area set aside for the preservation, protection and improvement of the natural environment through the management and maintenance of natural components and features found therein. A conservation area use may include nature based recreation, recreation trails, outdoor education and non-destructive research.

**GOLF COURSE** means an area of land used for the purpose of playing golf and may include a club house and curling arena as accessory uses.”
- 2. Section 1, (DEFINITIONS) is hereby amended by deleting the definition of “PARK” and substituting the following therefor:**

**“PARK** means an area of open space, generally characterized by its natural, historic or landscape features, which is used for passive or active recreation purposes, and may include facilities and buildings that would be ancillary, incidental and support the pursuit of outdoor recreation activity as the primary use of the property.”
- 3. Section 6.4 (TEMPORARY BUILDINGS - COMMERCIAL DISTRICT) is hereby deleted and the following substituted therefor:**

**“ TEMPORARY BUILDINGS - COMMERCIAL AND OPEN SPACE DISTRICTS**  
6.40 Any use of land within a commercial district, an OS.1 and an OS.2 district which involves a temporary building shall be prohibited, unless approved by a minor variance or an amendment to this by-law. A tent may be erected to support a permitted use for no more than ten days.”
- 4. Sections 24, 25, 26 and 26B are hereby deleted and the following substituted therefor:**

**" SECTION 24  
OPEN SPACE DISTRICT 1 (OS.1)**

**PERMITTED USES**

- 24.1 No person shall within any OS.1 District use any land for any purpose other than a conservation area..

**REGULATIONS**

- 24.2 No building shall be permitted.
- 24.3 OS.1 District is hereby designated as an open space district.

**" SECTION 25  
OPEN SPACE DISTRICT 2 (OS.2)**

**PERMITTED USES**

25.1 No person shall within any OS.2 District use any land for any purpose other than those uses listed below:

- (a) a conservation area
- (b) a park
- (c) an outdoor pool
- (d) a golf course
- (e) a botanical garden

**REGULATIONS**

25.2 No person shall within any OS.2 District use any land or erect, alter or use any building or part thereof except in accordance with the following regulations:

<b>Type</b>	<b>Requirement</b>
a) Minimum building setback from all lot lines	9 meters
b) Maximum building coverage	5 %
c) Minimum width of landscaped open space required to be established and maintained along all lot lines except where interrupted by driveways.	9 meters

25.3 OS.2 District is hereby designated as an open space district."

**" SECTION 26  
OPEN SPACE DISTRICT 3 (OS.3)**

**PERMITTED USES**

26.1 No person shall within any OS.3 District use any land for any purpose other than those uses listed below:

- (a) a purpose permitted under OS.2
- (b) a campground
- (c) a fairground
- (d) a cemetery

**REGULATIONS**

26.2 No person shall within any OS.3 District use any land or erect, alter or use any building or part thereof except in accordance with the following regulations:

<b>Type</b>	<b>Requirement</b>
a) Minimum building setback from all lot lines	9 meters
b) Maximum building coverage	5 %
c) Minimum width of landscaped open space required to be established and maintained along all lot lines except where interrupted by driveways.	9 meters

26.3 OS.3 District is hereby designated as an open space district."

**5. Sections 22 is hereby deleted and the following substituted therefor:**

**" SECTION 22A  
PUBLIC SERVICE DISTRICT 1 (PS.1)**

**PERMITTED USES**

22A.1 No person shall within any PS.1 District use any land for any purpose other than those uses listed below:

- (a) a park
- (b) an indoor swimming pool
- (c) an arena, skating or curling rink
- (d) a recreation centre
- (e) a library
- (f) a day nursery
- (g) a firehall
- (h) an ambulance station
- (i) a public utilities installation
- (j) a museum or art gallery

**REGULATIONS**

22A.2 No person shall within any PS.1 District use any land or erect, alter or use any building or part thereof except in accordance with the following regulations:

<b>Type</b>	<b>Requirement</b>
a) Minimum lot width	18 meters
b) Minimum lot depth	30 meters
c) Minimum building setback from side or rear lot lines	the greater of 3 meters or the height of the building
d) Maximum building coverage	40 %
e) Minimum width of landscaped open space required to be established and maintained along all lot lines except where interrupted by driveways	3 meters
f) No open storage is permitted except for recreation equipment	

22A.3 PS.1 District is hereby designated as a public service district."

**" SECTION 22B  
PUBLIC SERVICE DISTRICT 2 (PS.2)**

**PERMITTED USES**

22B.1 No person shall within any PS.2 District use any land for any purpose other than those uses listed below:

- (a) a purpose permitted under PS.1
- (b) a public administration establishment
- (c) a police station
- (d) a school
- (e) a hospital
- (f) a nursing home
- (g) a home for the aged
- (h) a group home
- (i) a monastery, convent or religious establishment
- (j) a church

- (k) a place of assembly

**REGULATIONS**

22B.2 No person shall within any PS.2 District use any land or erect, alter or use any building or part thereof except in accordance with the following regulations:

<b>Type</b>	<b>Requirement</b>
a) Minimum lot width	18 meters
b) Minimum lot depth	30.meters
c) Minimum building setback from side or rear lot lines	the greater of 3 meters or the height of the building
d) Maximum building coverage	40 %
e) Minimum width of landscaped open space required to be established and maintained along all lot lines except where interrupted by driveways.	3 meters
f) No open storage is permitted except for recreation equipment	

22B.3 PS.2 District is hereby designated as a public service district."

- 6. **Schedule A to By-law 97-123 is hereby amended as shown on the maps attached as Schedule A to this By-law.**
- 7. **This by-law shall come into effect upon the approval of Official Plan Amendment Number 112.**

By-law read a first and second time this 2nd day of October, 2000.

By-law read a third time and finally passed this 2nd day of October, 2000.

(sgd.) Sylvia Sutherland, Mayor

(sgd.) Steven Brickell, Clerk



# SCHEDULE - 'A' TO BYLAW 1997-123 KEY MAP

SCHEDULE 'A' TO  
BYLAW 2000-114  
PASSED THE 2<sup>ND</sup> DAY  
OF OCTOBER 2000  
MAYOR *D. [Signature]*  
CLERK *[Signature]*

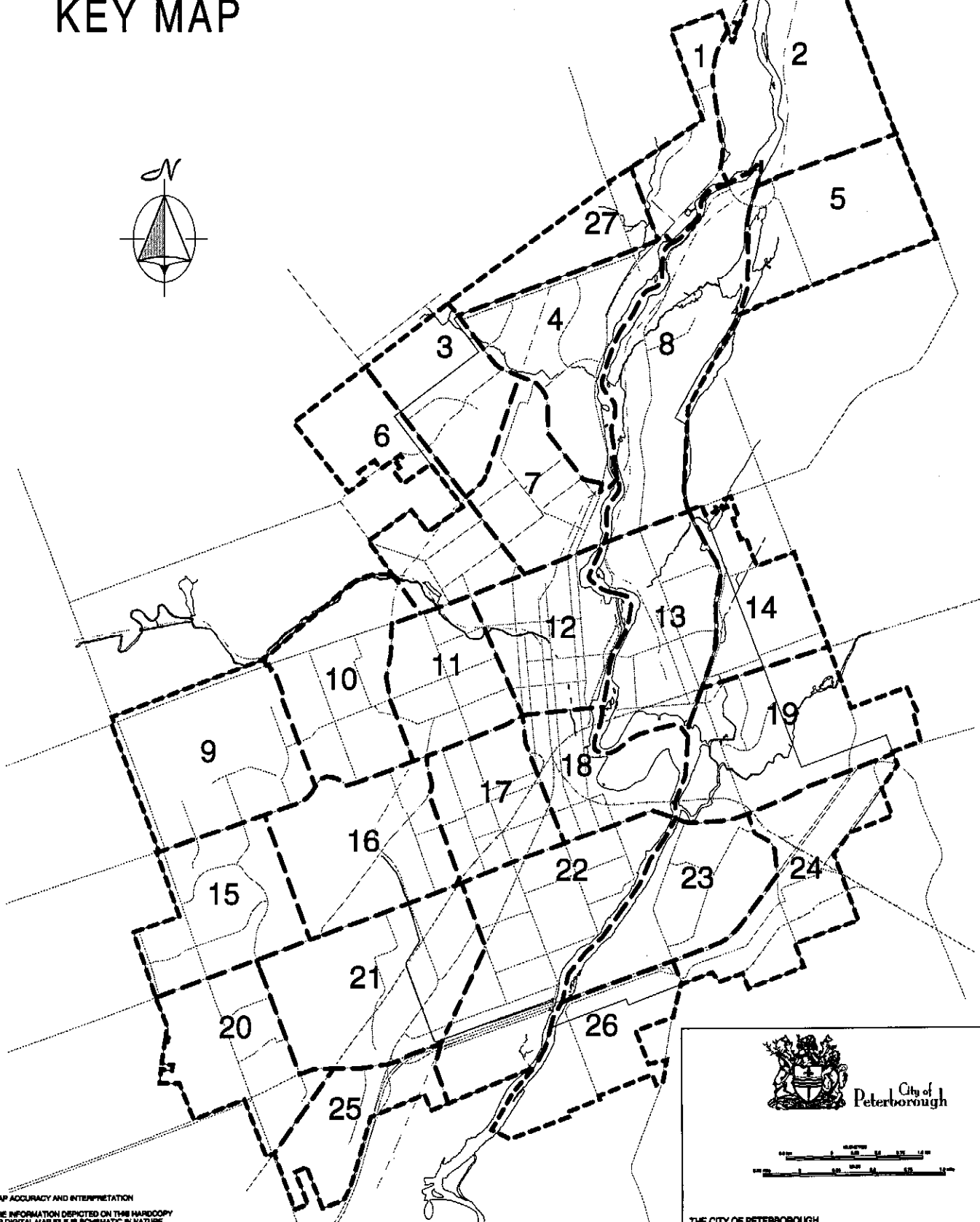
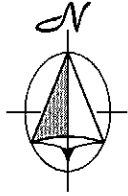

MAP ACCURACY AND INTERPRETATION  
THE INFORMATION DEPICTED ON THIS HARD COPY  
OR DIGITAL MAP FILE IS SCHEMATIC IN NATURE.  
ACCURATE INTERPRETATION OF INFORMATION  
SHOWN SHOULD BE OBTAINED FROM APPROPRIATE  
CITY PLANNING STAFF



City of  
Peterborough



THE CITY OF PETERBOROUGH  
PLANNING AND DEVELOPMENT SERVICES  
CARTOGRAPHY

June 2000

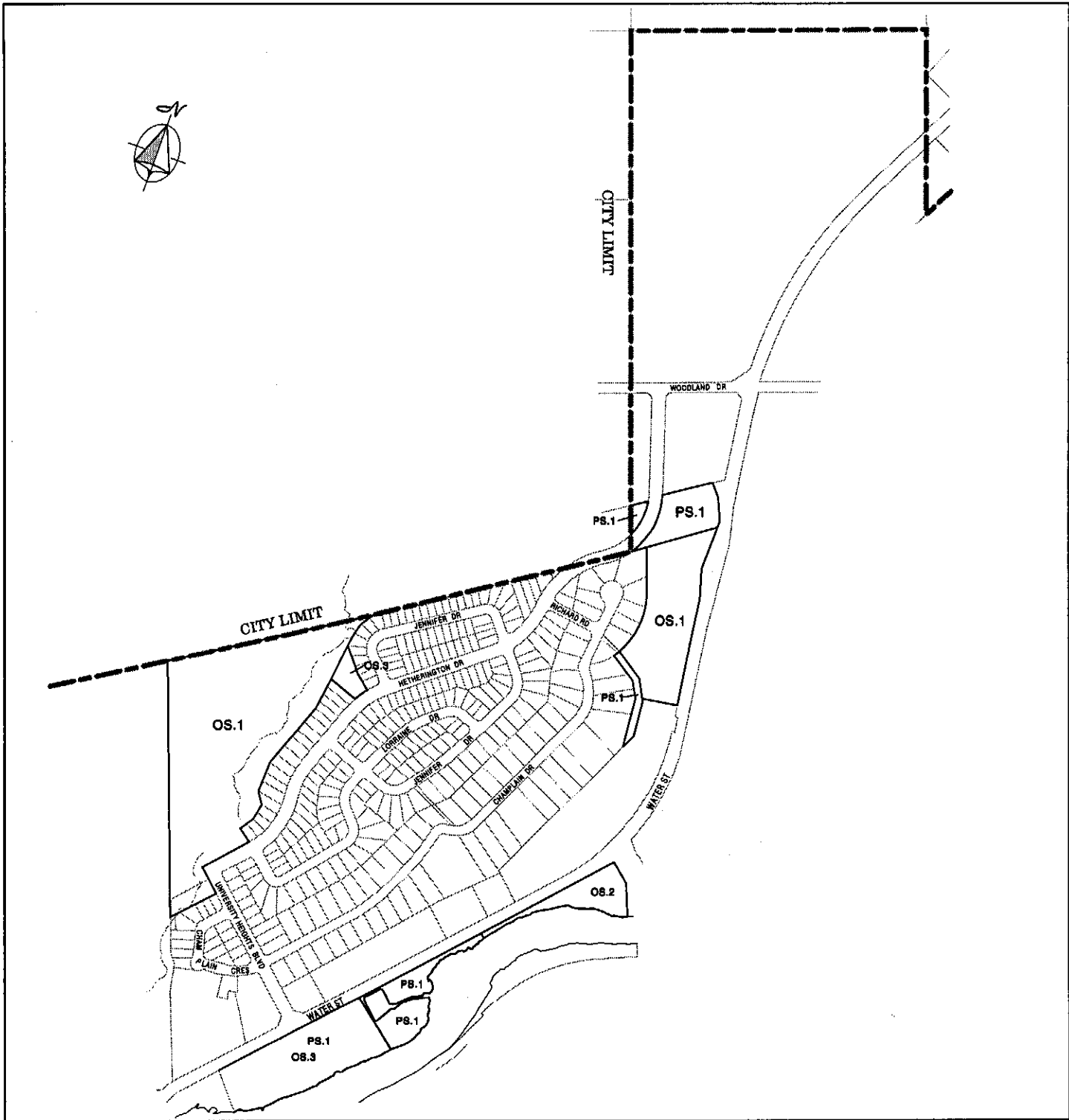

**Details**

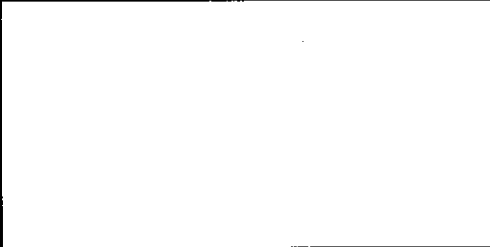

City of  
**Peterborough**  
METRES

100 80 0 125 250



500 0 FEET 500 1000



The City of Peterborough,  
Planning and Development Services.

# Map No. 1

This map is current to June 27, 2000

**MAP ACCURACY AND INTERPRETATION**

The information depicted on this hardcopy or digital map file is schematic in nature. Accurate interpretation of information shown, should be obtained from appropriate City staff.

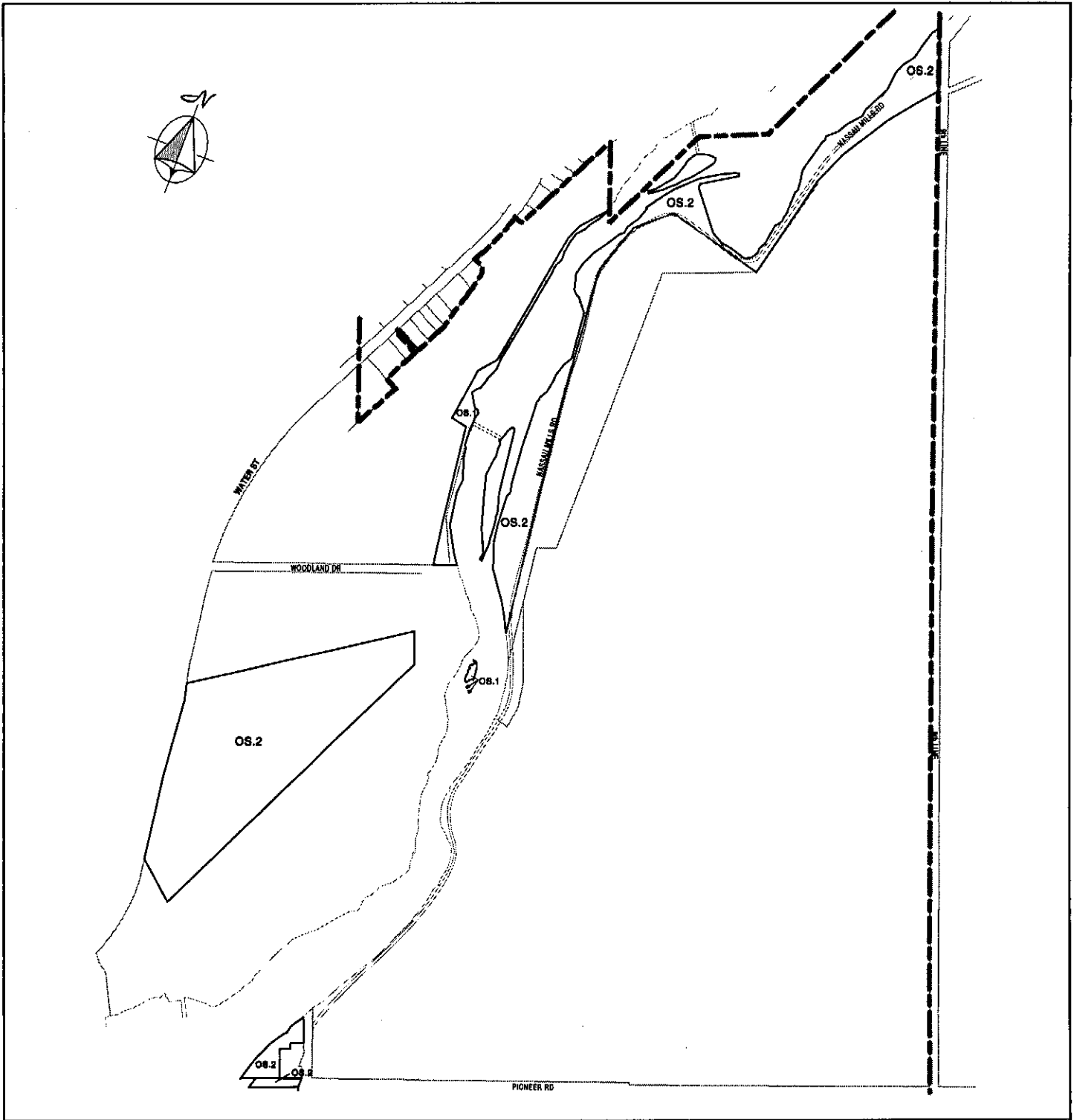

**Details**

--	--



City of  
**Peterborough**



The City of Peterborough,  
Planning and Development Services.

# Map No. 2

This map is current to June, 2000

**MAP ACCURACY AND INTERPRETATION**

The information depicted on this hardcopy or digital map file is schematic in nature. Accurate interpretation of information shown, should be obtained from appropriate City staff.



CHENONG RD

CHENONG RD

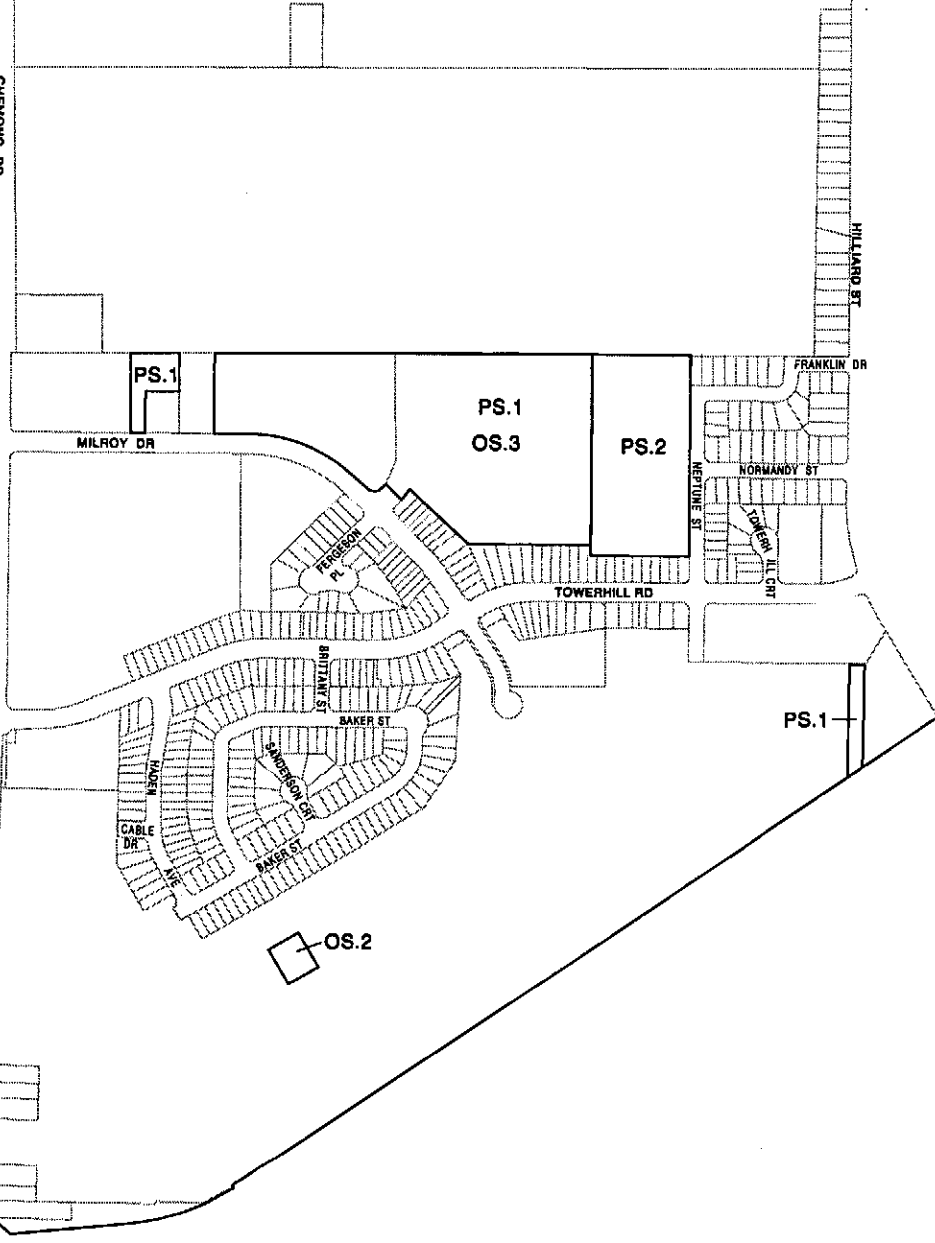

**Details**



City of Peterborough

METRES  
100 50 0 125 250

FEET  
600 0 600 1000

The City of Peterborough,  
Planning and Development Services.

# Map No. 3

This map is current to June 2000

**MAP ACCURACY AND INTERPRETATION**

The information depicted on this hardcopy or digital map file is schematic in nature.  
Accurate interpretation of information shown, should be obtained from appropriate City staff.

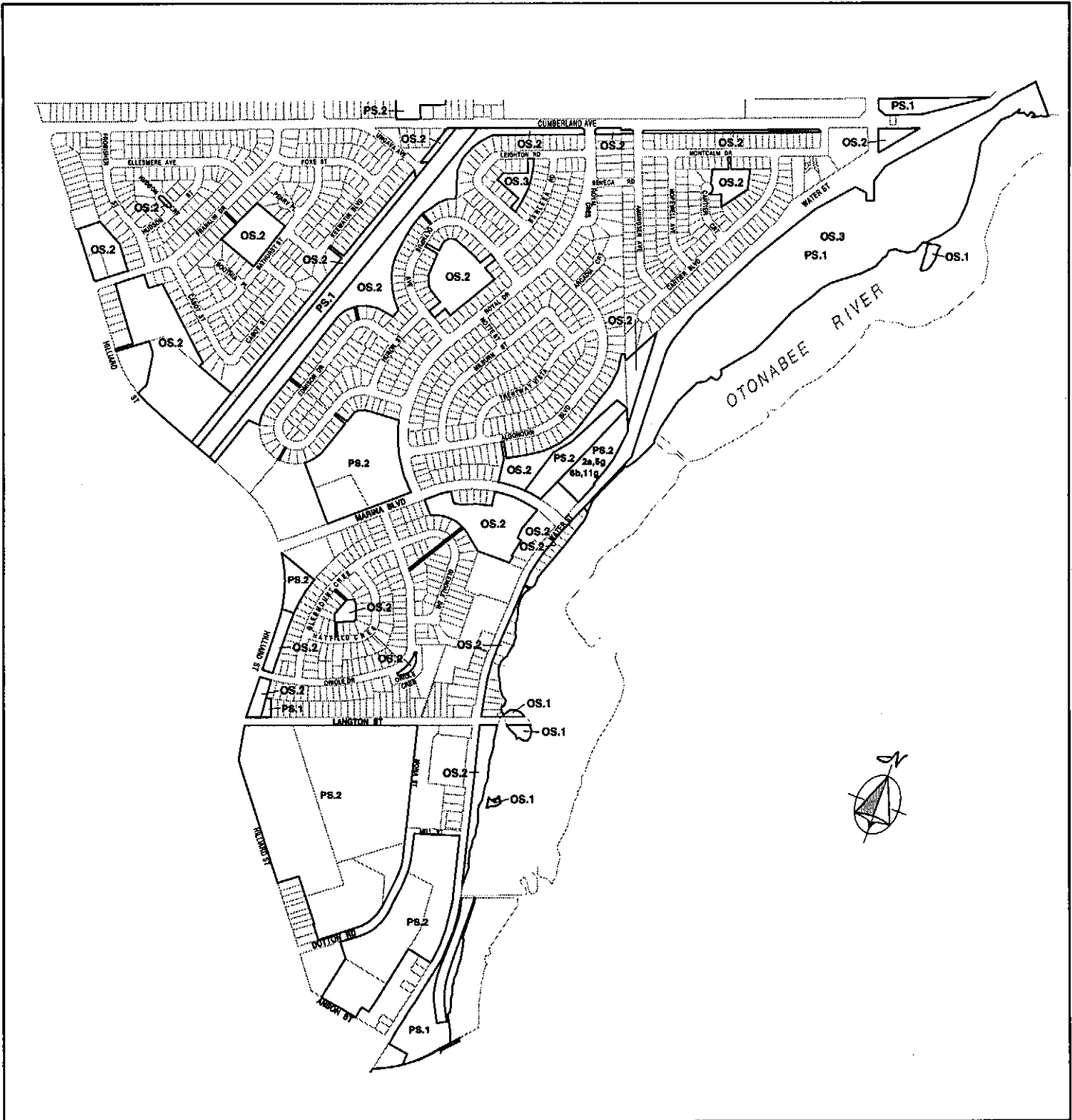

**Details**



City of Peterborough



The City of Peterborough,  
Planning and Development Services.

**Map No. 4**

This map is current to June 2000

**MAP ACCURACY AND INTERPRETATION**

The information depicted on this hardcopy or digital map file is schematic in nature. Accurate interpretation of information shown, should be obtained from appropriate City staff.

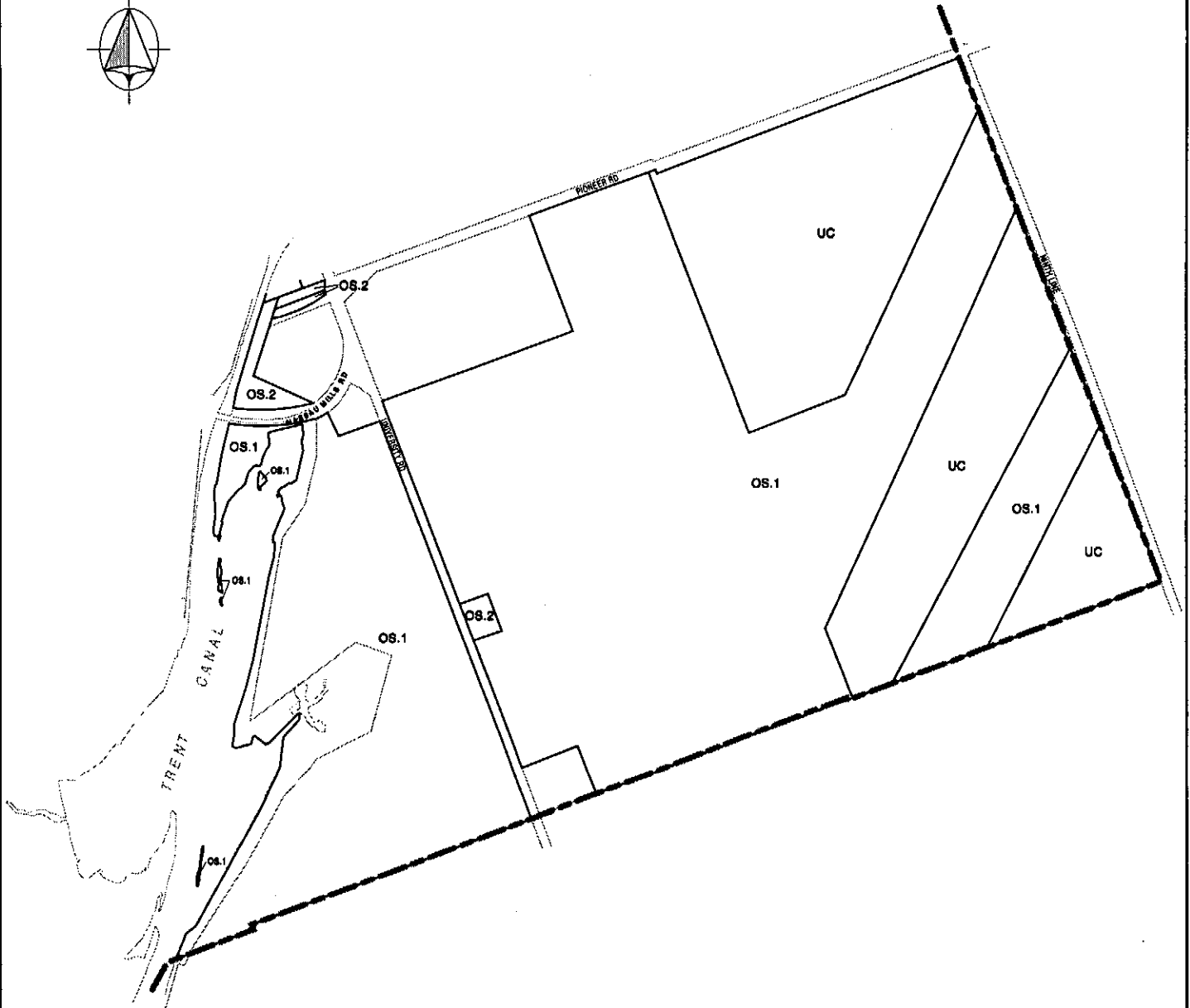
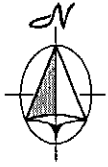

**Details**



The City of Peterborough,  
Planning and Development Services.

# Map No. 5

This map is current to June 2000

**MAP ACCURACY AND INTERPRETATION**

The information depicted on this hardcopy or digital map file is schematic in nature. Accurate interpretation of information shown, should be obtained from appropriate City staff.

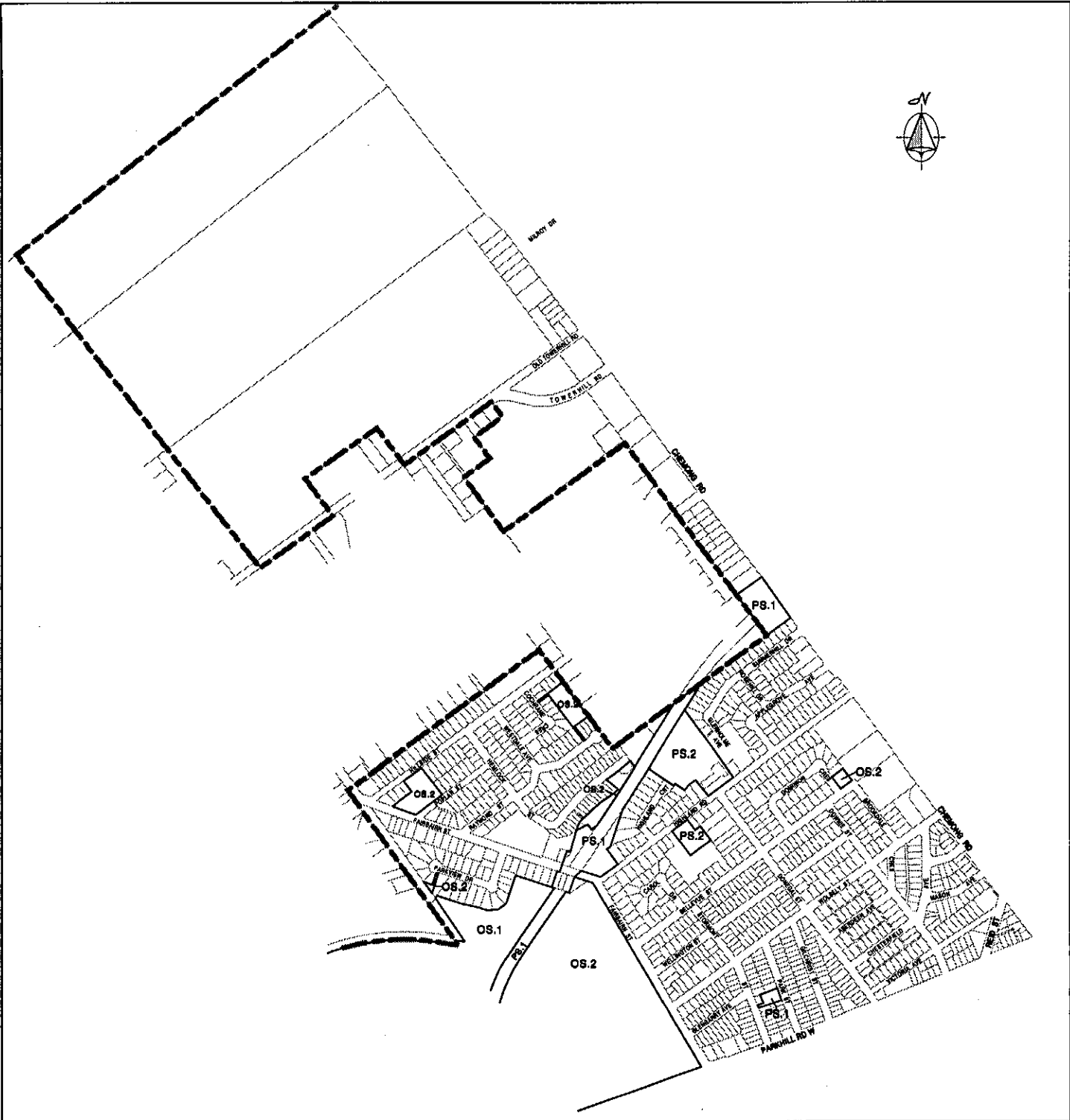

**Details**

--	--



City of Peterborough



The City of Peterborough,  
Planning and Development Services.

# Map No. 6

This map is current to June 2000

**MAP ACCURACY AND INTERPRETATION**

The information depicted on this hardcopy or digital map file is schematic in nature. Accurate interpretation of information shown, should be obtained from appropriate City staff.

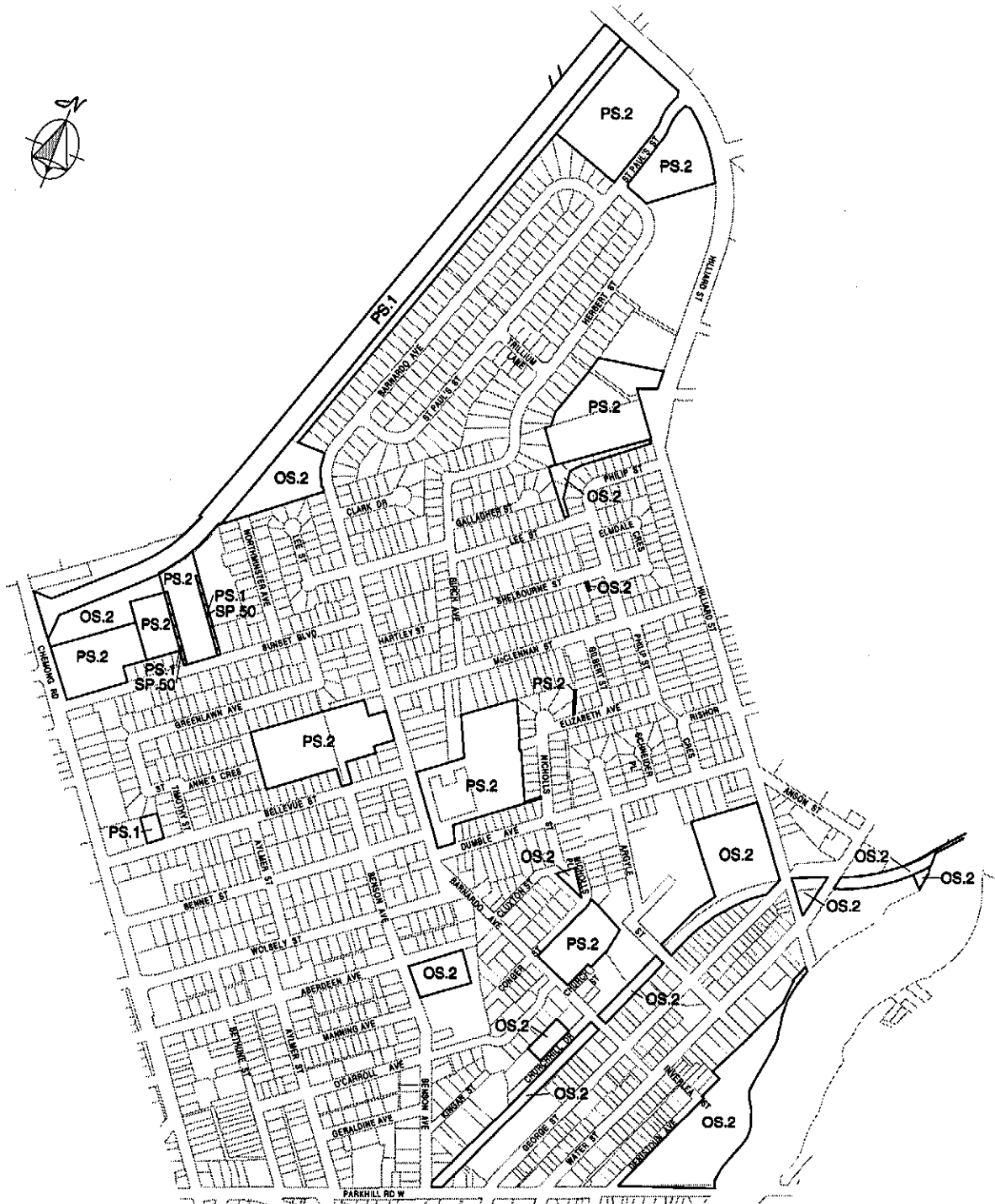

**Details**



City of  
**Peterborough**



The City of Peterborough,  
Planning and Development Services.

**Map No. 7**

This map is current to June 2000

**MAP ACCURACY AND INTERPRETATION**

The information depicted on this hardcopy or digital map file is schematic in nature. Accurate interpretation of information shown, should be obtained from appropriate City staff.

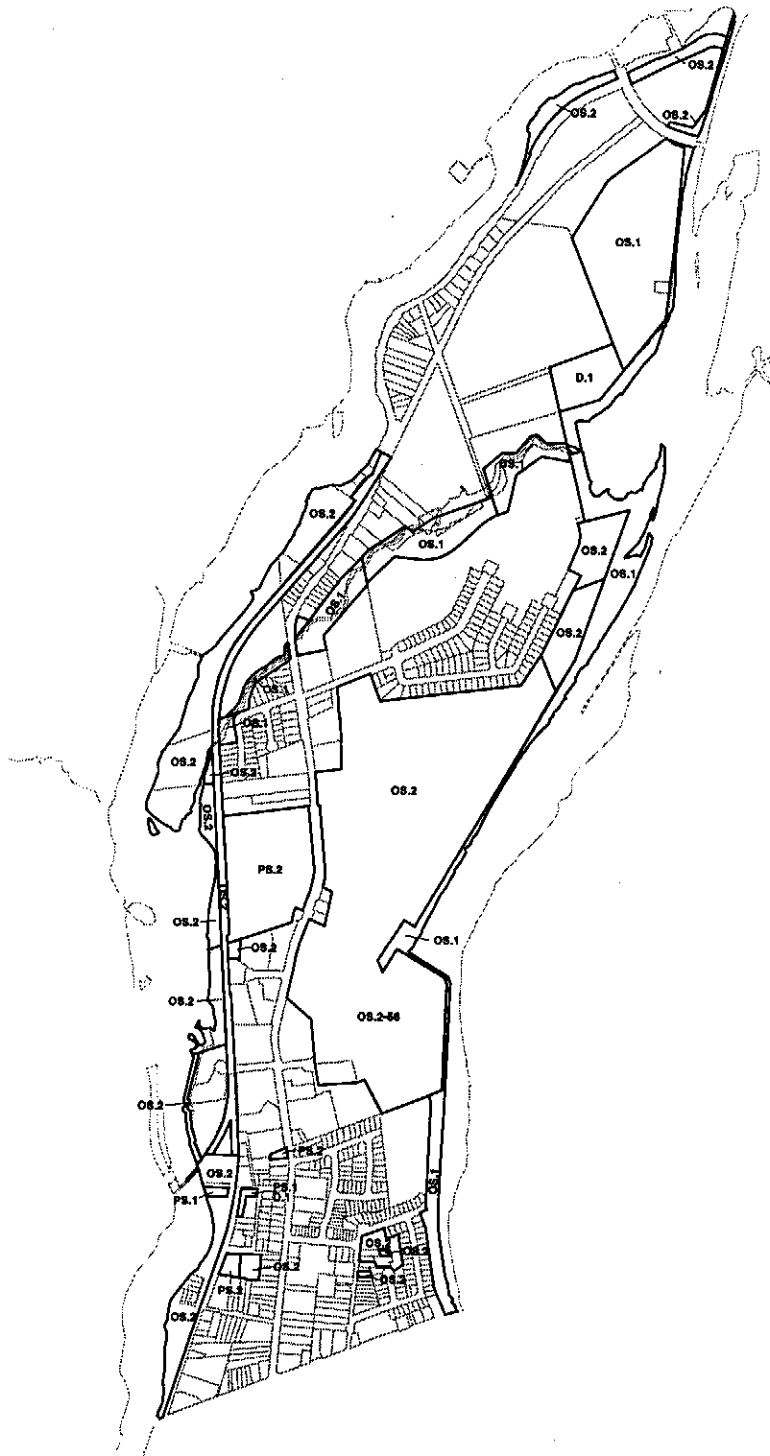

**Details**



City of  
**Peterborough**



The City of Peterborough,  
Planning and Development Services.

# Map No. 8

This map is current to June 2000

**MAP ACCURACY AND INTERPRETATION**

The information depicted on this hardcopy or digital map file is schematic in nature.  
Accurate interpretation of information shown, should be obtained from appropriate City staff.

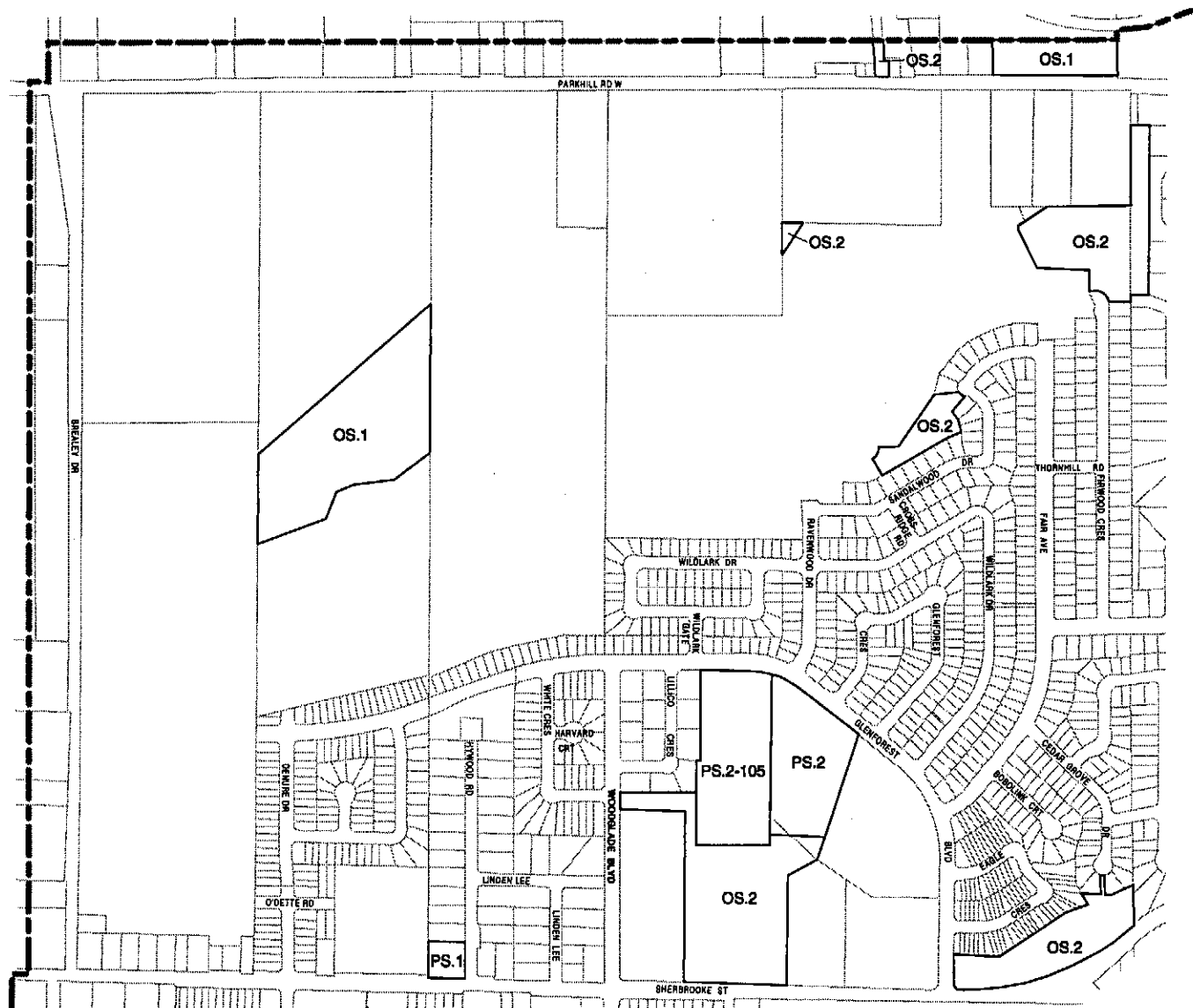

**Details**

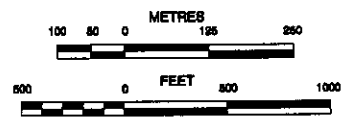

The City of Peterborough,  
Planning and Development Services.

# Map No. 9

This map is current to June 2000

**MAP ACCURACY AND INTERPRETATION**

The information depicted on this hardcopy or digital map file is schematic in nature. Accurate interpretation of information shown, should be obtained from appropriate City staff.

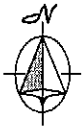

Detail 1



City of  
Peterborough

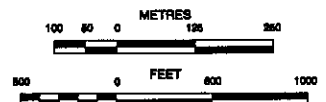

The City of Peterborough,  
Planning and Development Services.

# Map No. 10

This map is current to June 2000

### MAP ACCURACY AND INTERPRETATION

The information depicted on this hardcopy or digital map file is schematic in nature.  
Accurate interpretation of information shown, should be obtained from appropriate City staff.

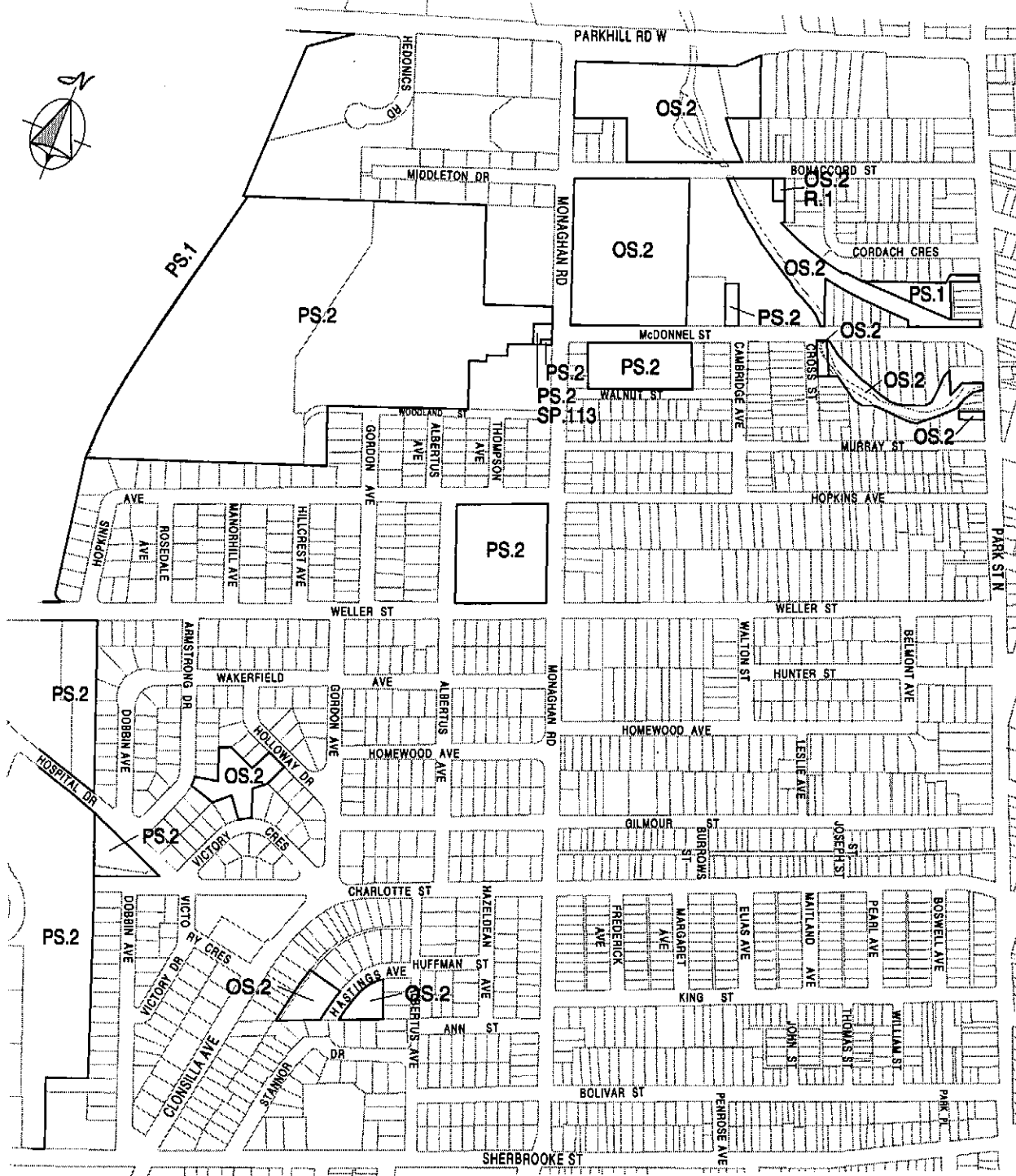

**Details**

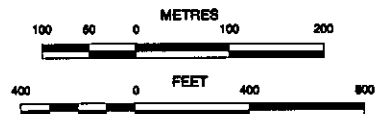

The City of Peterborough,  
Planning and Development Services.

**Map No. 11**

This map is current to June 2000

**MAP ACCURACY AND INTERPRETATION**

The information depicted on this hardcopy or digital map file is schematic in nature. Accurate interpretation of information shown, should be obtained from appropriate City staff.

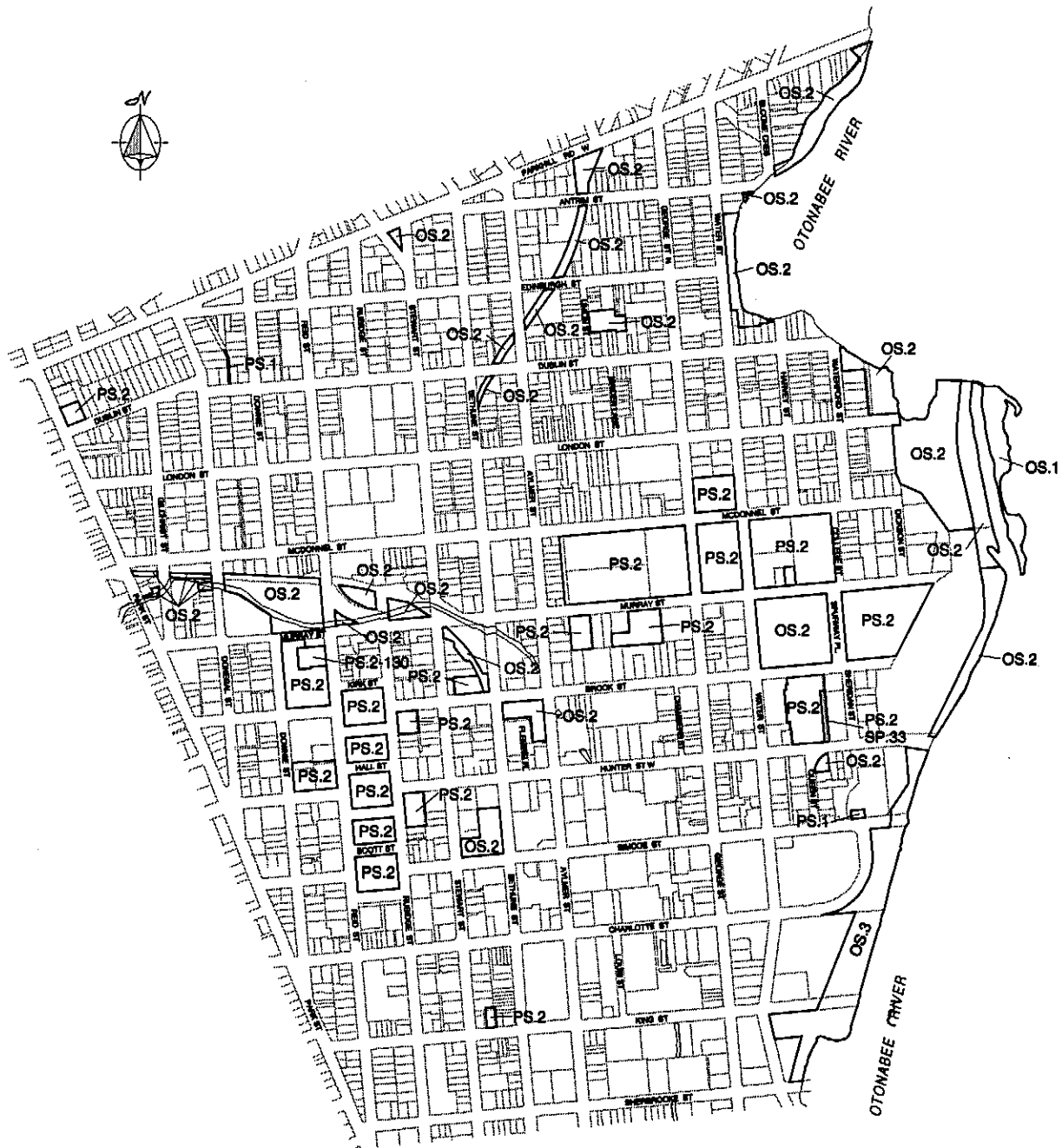

**Details**



City of  
Peterborough



The City of Peterborough,  
Planning and Development Services.

**Map No. 12**

This map is current to June 2000

**MAP ACCURACY AND INTERPRETATION**

The information depicted on this hardcopy or digital map file is schematic in nature. Accurate interpretation of information shown, should be obtained from appropriate City staff.



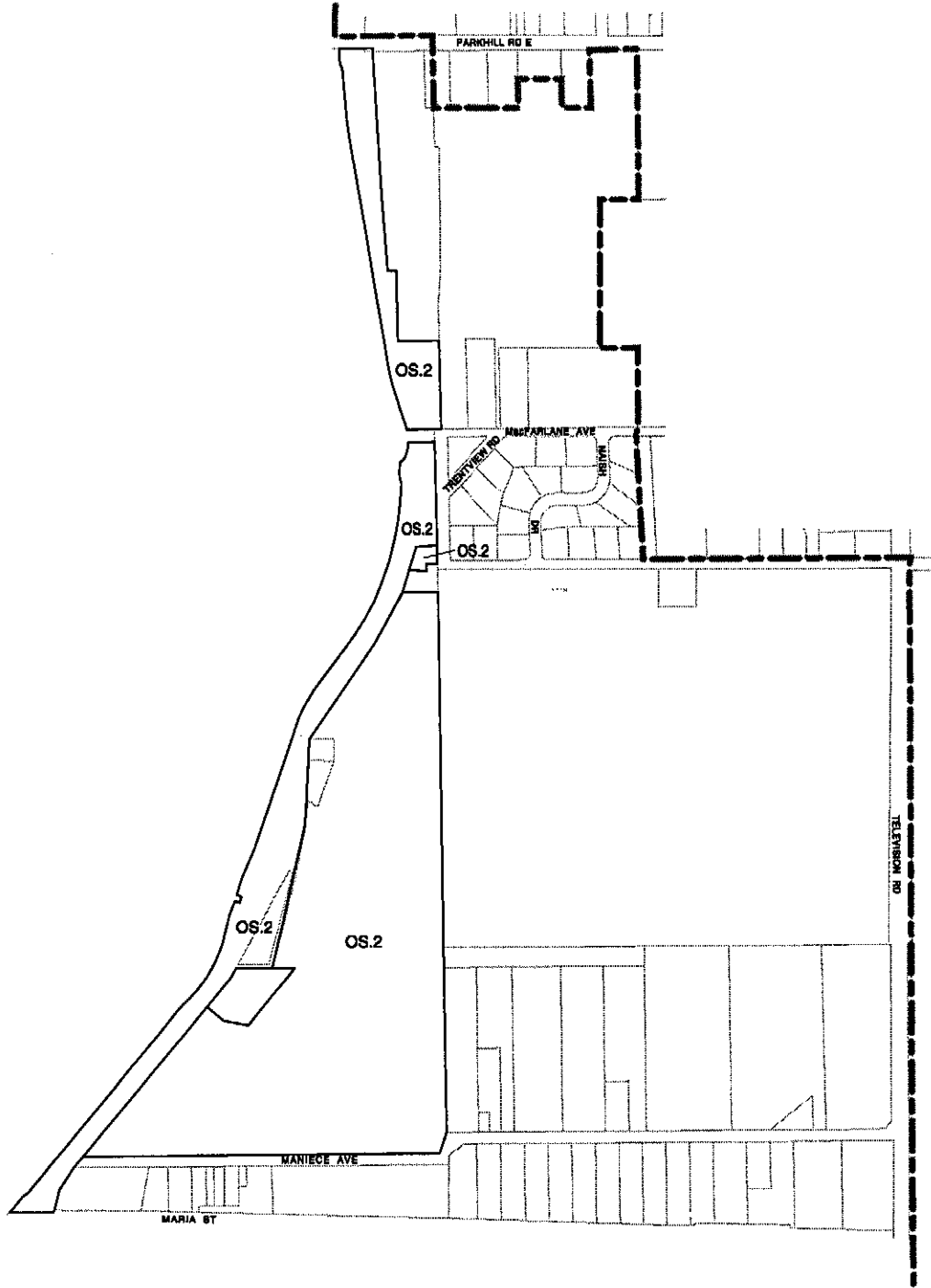

**Details**



City of  
**Peterborough**

METRES  
100 50 0 125 250



0 0 FEET 500 1000



The City of Peterborough,  
Planning and Development Services.

**Map No. 14**

This map is current to June 2000

**MAP ACCURACY AND INTERPRETATION**

The information depicted on this hardcopy or digital map file is schematic in nature.  
Accurate interpretation of information shown, should be obtained from appropriate City staff.

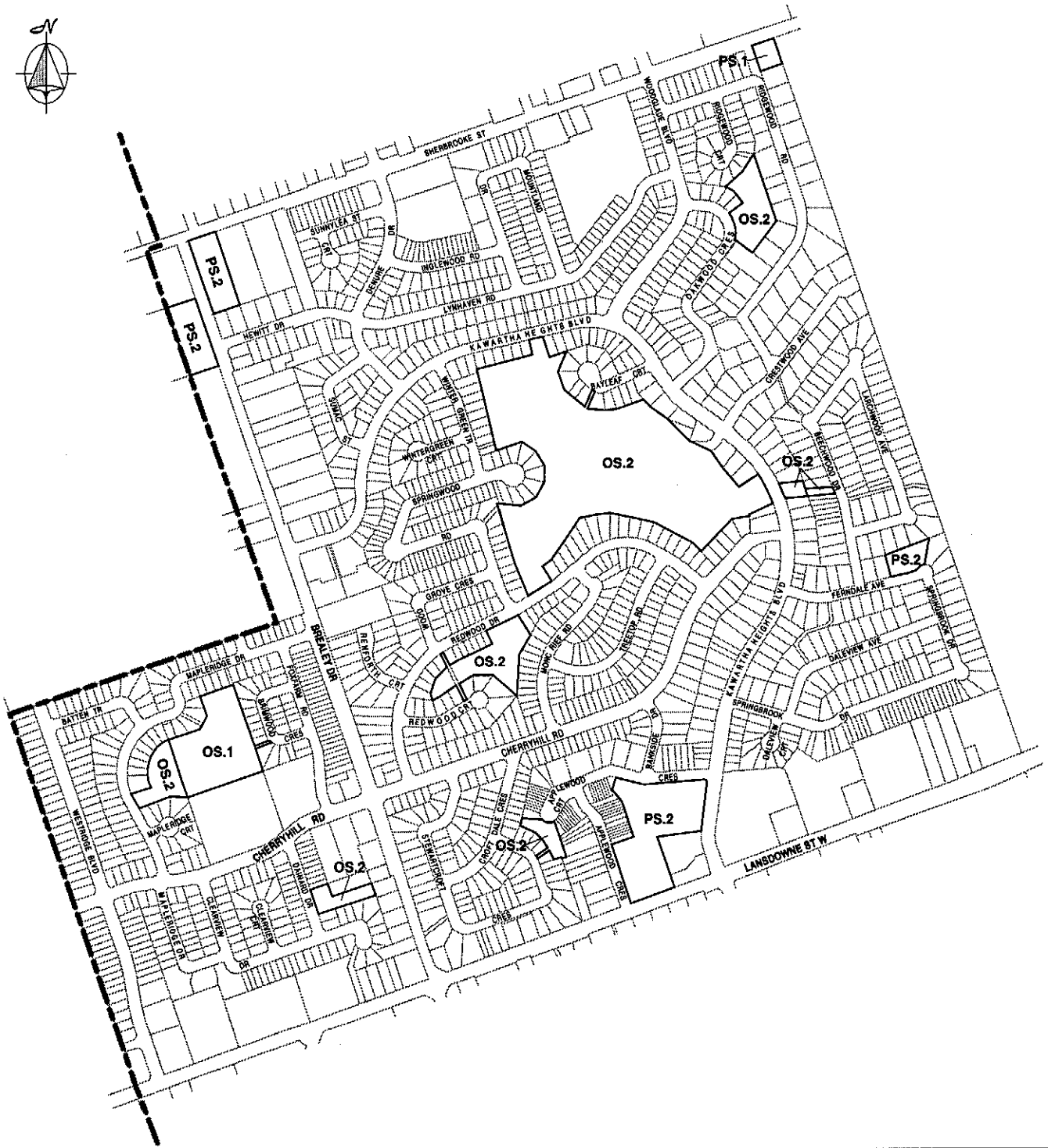

**Details**



City of  
**Peterborough**

100 50 0 METRES 125 250

500 0 FEET 500 1000

The City of Peterborough,  
Planning and Development Services.

# Map No. 15

This map is current to June 2000

**MAP ACCURACY AND INTERPRETATION**

The information depicted on this hardcopy or digital map file is schematic in nature. Accurate interpretation of information shown, should be obtained from appropriate City staff.

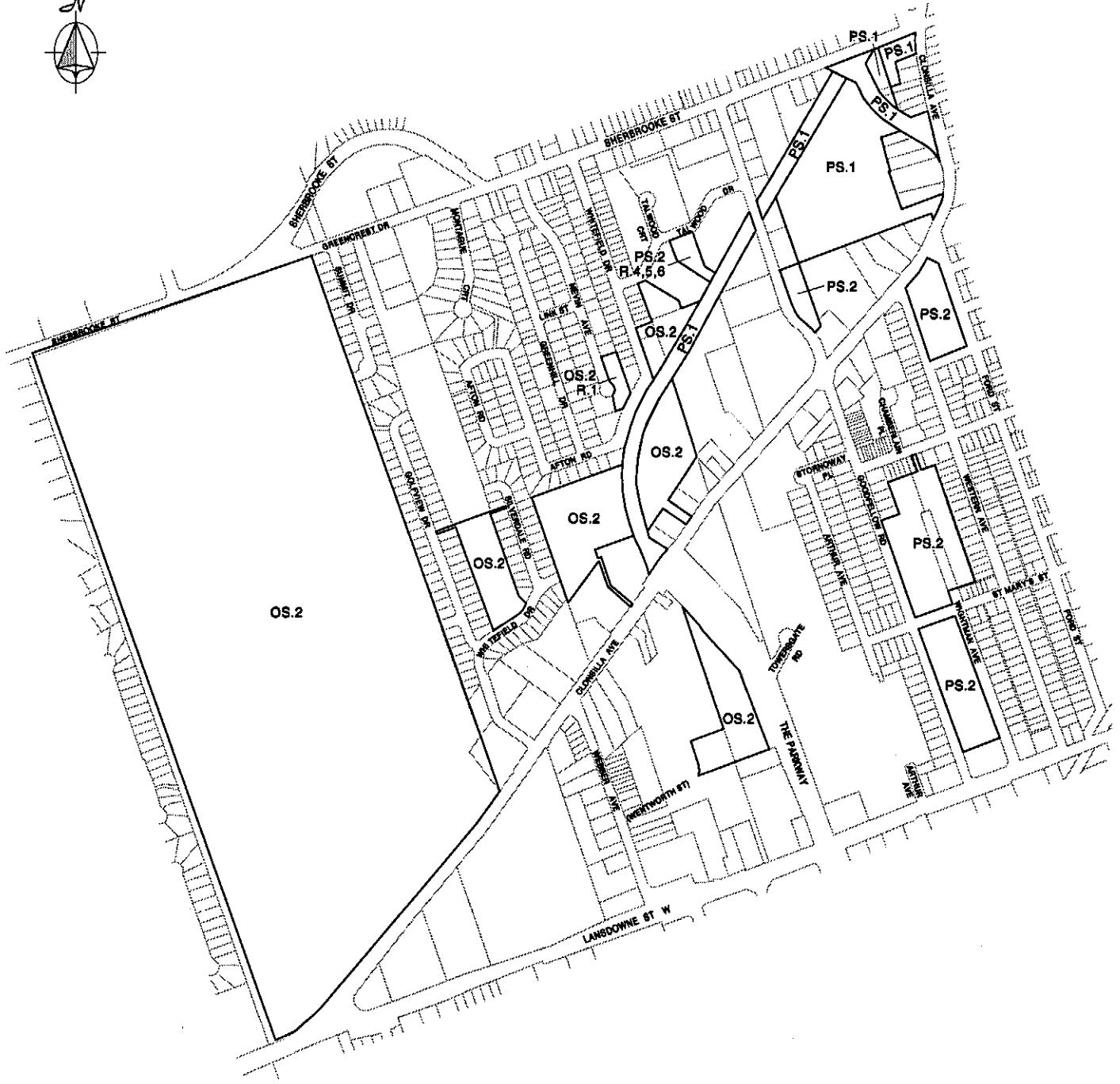

**Details**



City of  
**Peterborough**



The City of Peterborough,  
Planning and Development Services.

# Map No. 16

This map is current to June 2000

**MAP ACCURACY AND INTERPRETATION**

The information depicted on this hardcopy or digital map file is schematic in nature.  
Accurate interpretation of information shown, should be obtained from appropriate City staff.

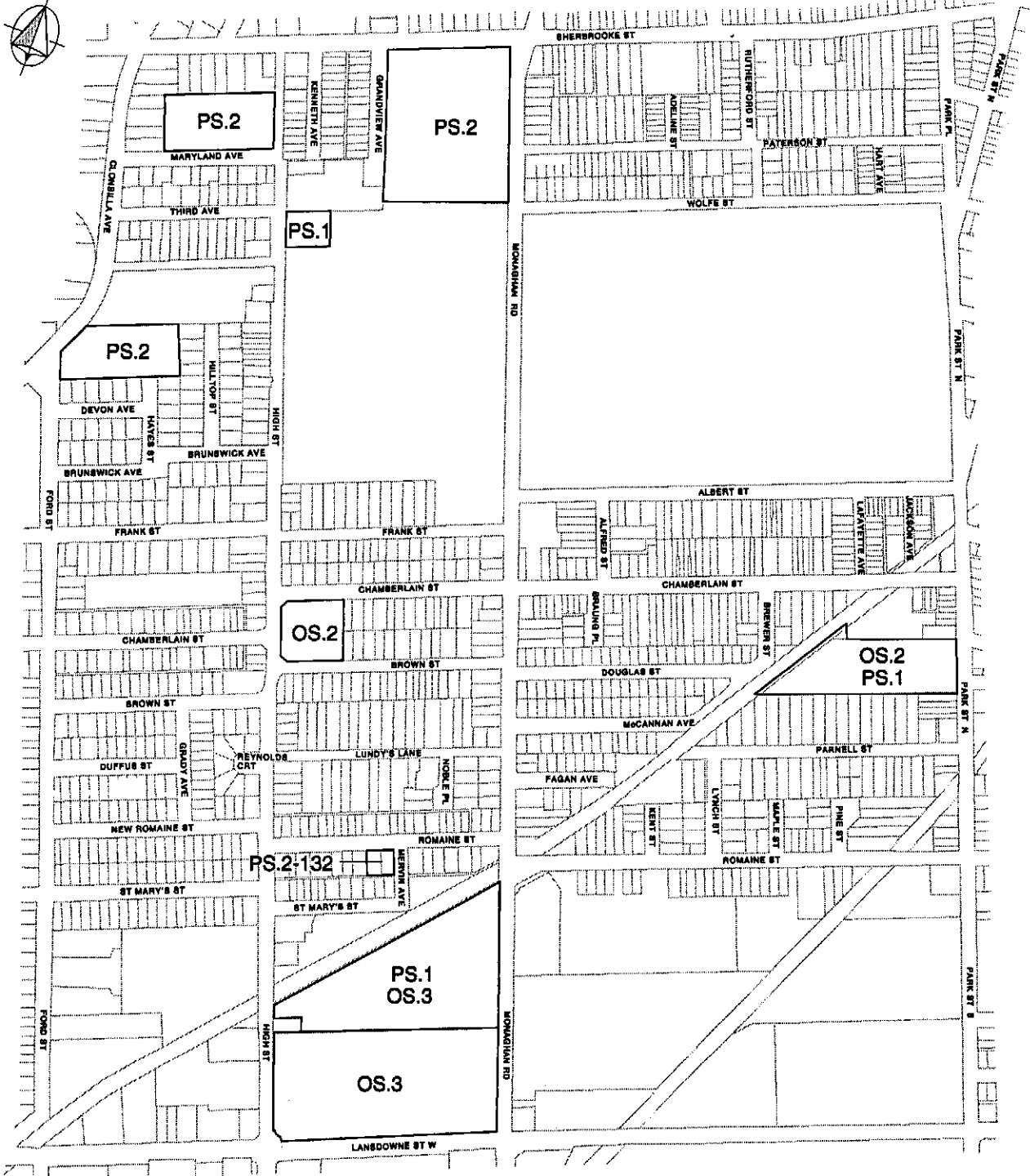

**Details**



**City of Peterborough**



The City of Peterborough,  
Planning and Development Services.

**Map No. 17**

This map is current to June 2000

**MAP ACCURACY AND INTERPRETATION**

The information depicted on this hardcopy or digital map file is schematic in nature. Accurate interpretation of information shown, should be obtained from appropriate City staff.

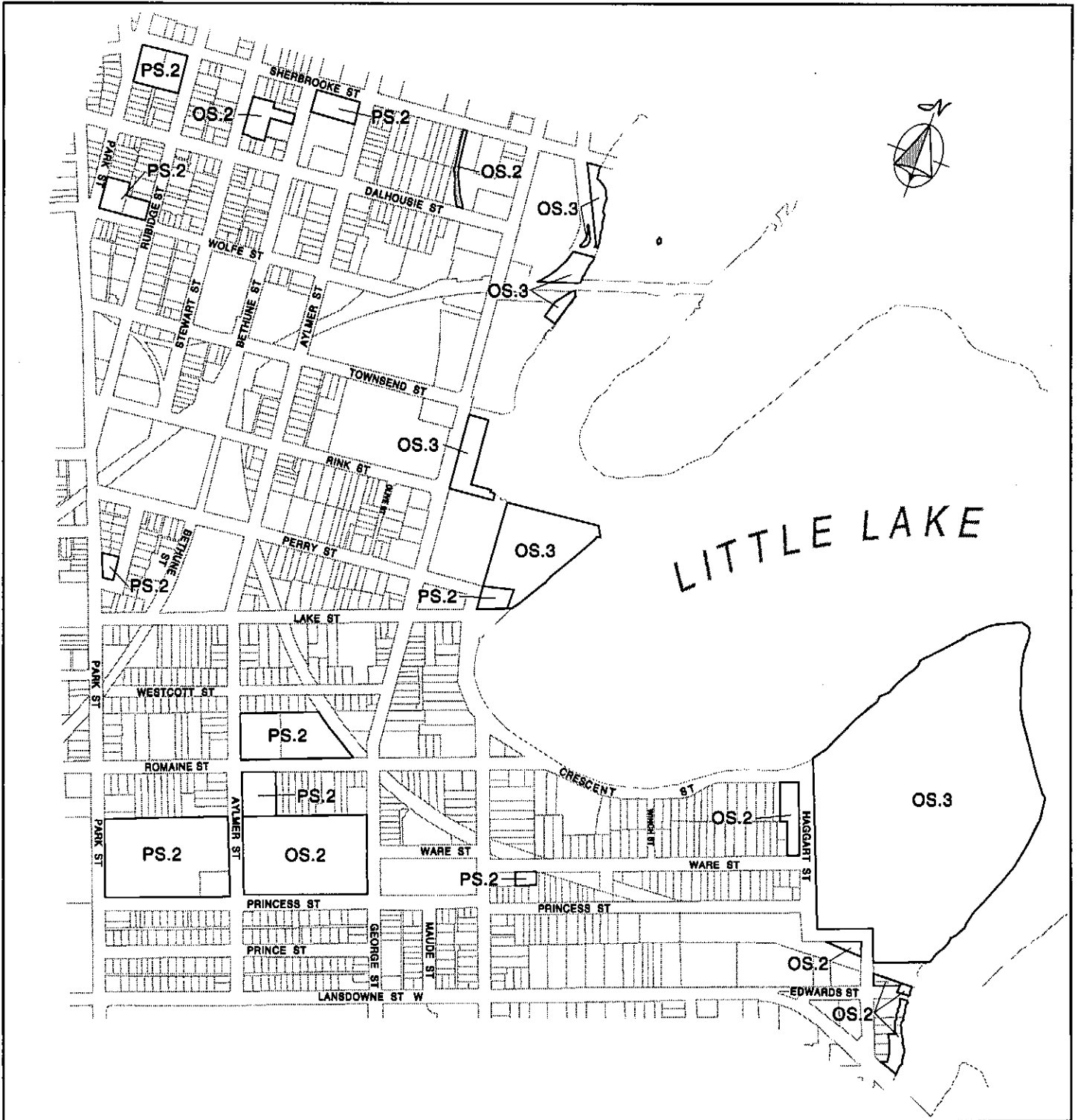

**Details**

--	--



City of Peterborough

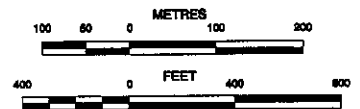

The City of Peterborough,  
Planning and Development Services.

**Map No. 18**

This map is current to June 2000

**MAP ACCURACY AND INTERPRETATION**

The information depicted on this hardcopy or digital map file is schematic in nature. Accurate interpretation of information shown, should be obtained from appropriate City staff.

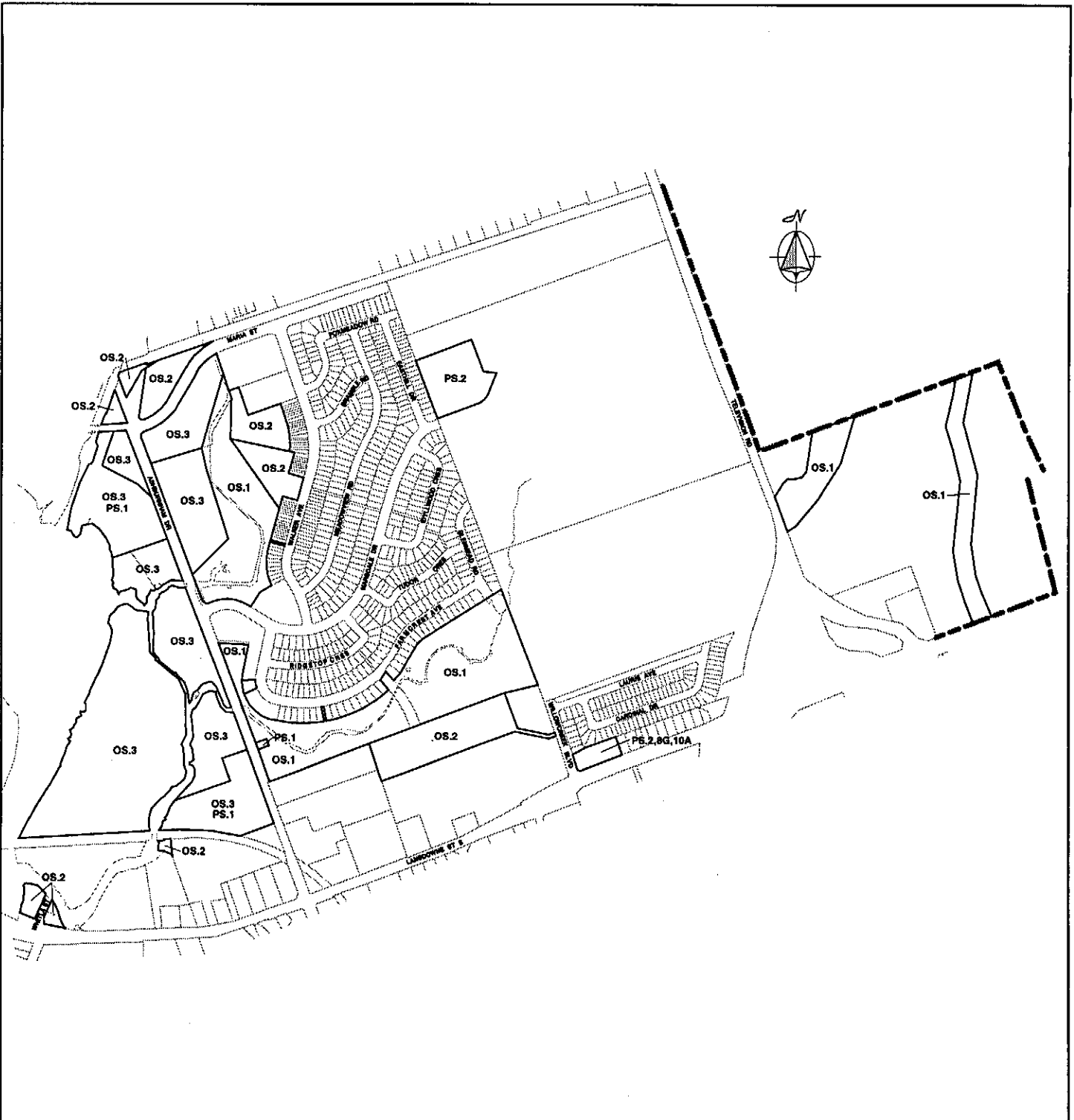

**Details**

--	--



The City of Peterborough,  
Planning and Development Services.

# Map No. 19

This map is current to June 2000

**MAP ACCURACY AND INTERPRETATION**

The information depicted on this hardcopy or digital map file is schematic in nature. Accurate interpretation of information shown, should be obtained from appropriate City staff.

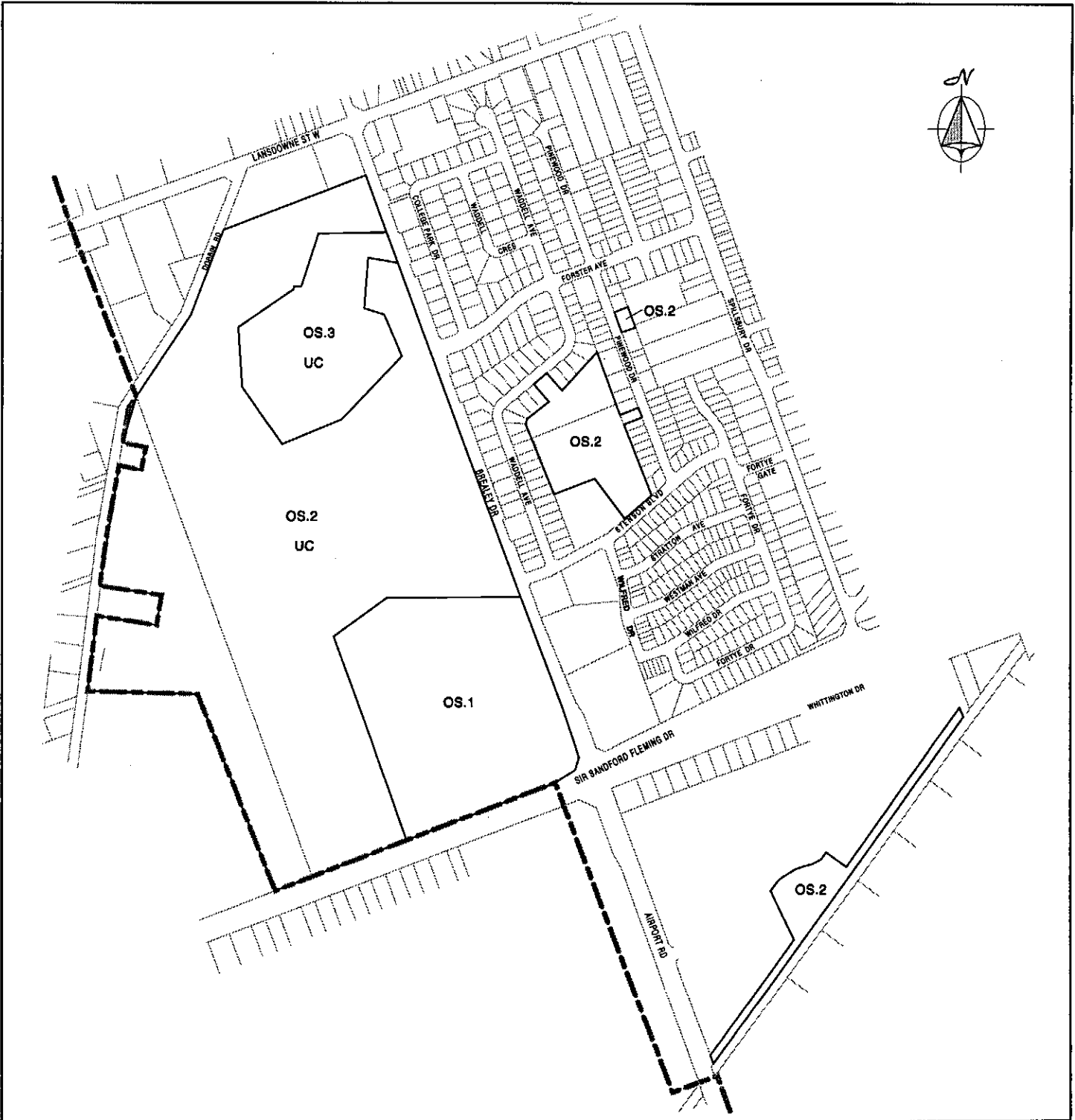

**Details**

--	--	--



**City of Peterborough**

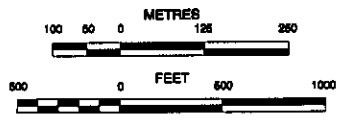

The City of Peterborough,  
Planning and Development Services.

# Map No. 20

This map is current to June 2000

**MAP ACCURACY AND INTERPRETATION**

The information depicted on this hardcopy or digital map file is schematic in nature. Accurate interpretation of information shown, should be obtained from appropriate City staff.

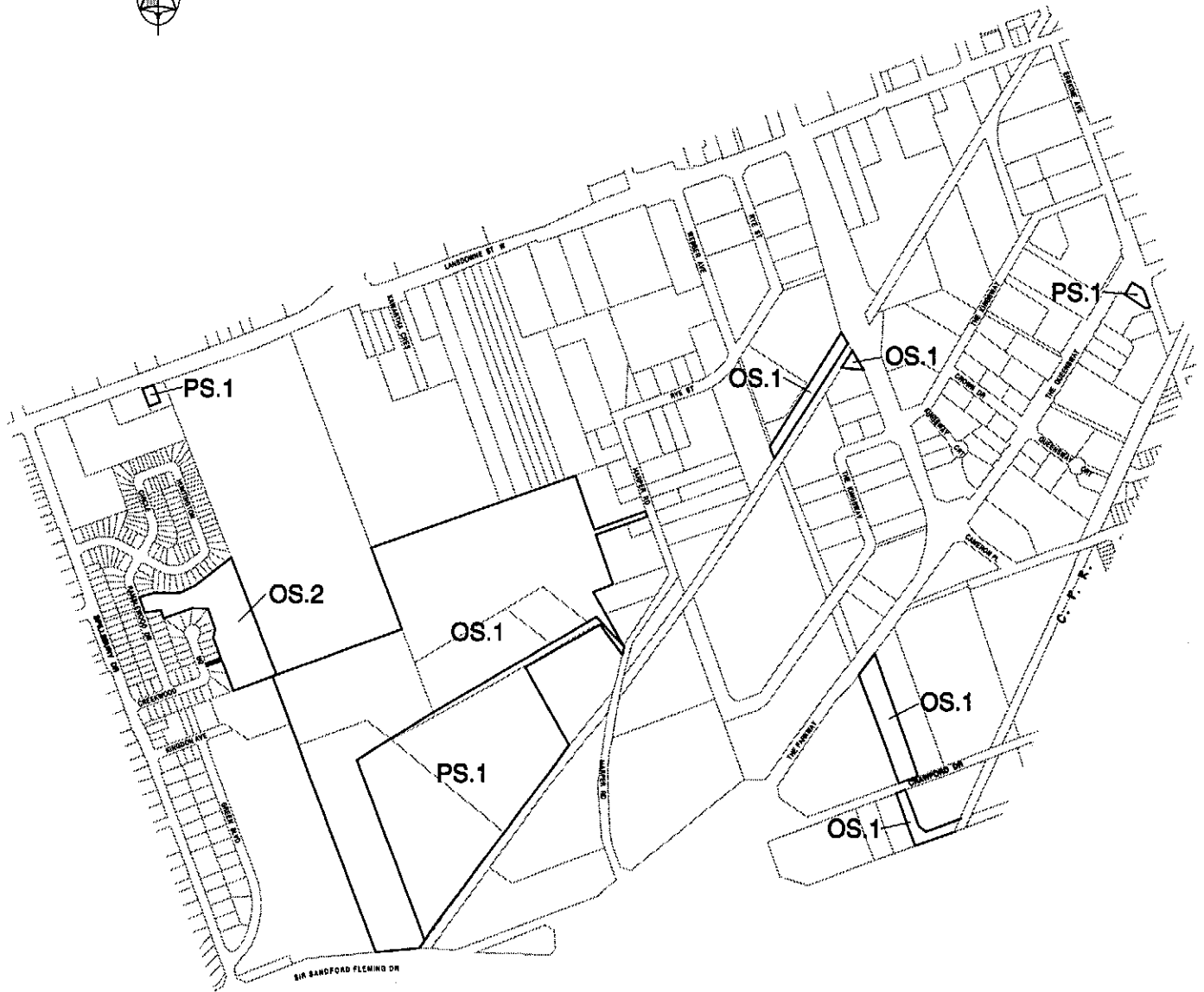

Details



The City of Peterborough,  
Planning and Development Services.

# Map No. 21

This map is current to June 2000

**MAP ACCURACY AND INTERPRETATION**

The information depicted on this hardcopy or digital map file is schematic in nature.  
Accurate interpretation of information shown, should be obtained from appropriate City staff.



**Details**

--	--



City of Peterborough



The City of Peterborough,  
Planning and Development Services.

**Map No. 22**

**MAP ACCURACY AND INTERPRETATION**

The information depicted on this hardcopy or digital map file is schematic in nature. Accurate interpretation of information shown, should be obtained from appropriate City staff.

This map is current to June 2000

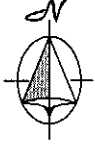

Detail 1

Detail 2



City of Peterborough



The City of Peterborough,  
Planning and Development Services.

# Map No. 23

This map is current to June 2000

### MAP ACCURACY AND INTERPRETATION

The information depicted on this hardcopy or digital map file is schematic in nature. Accurate interpretation of information shown, should be obtained from appropriate City staff.

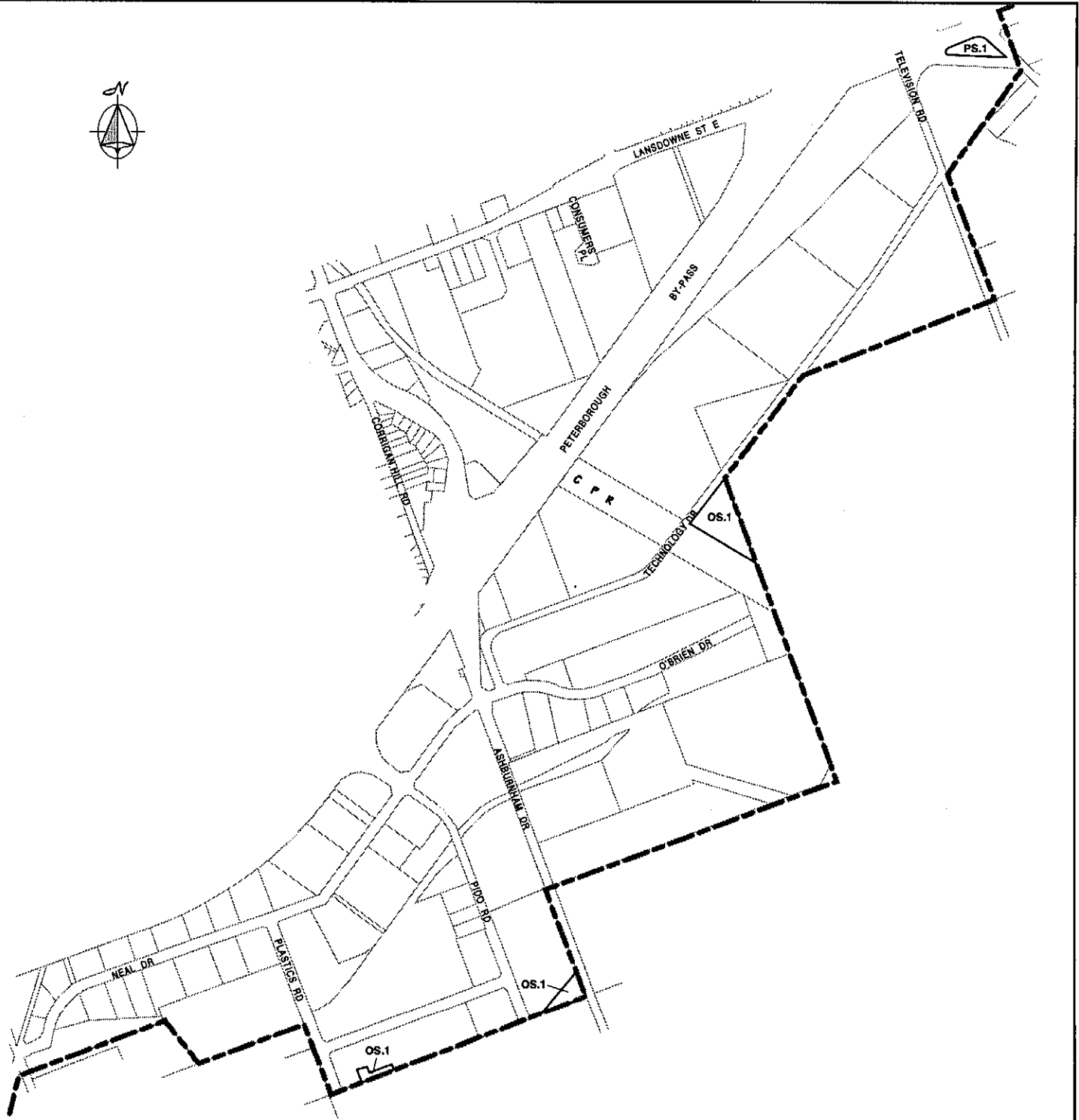

**Details**



**City of Peterborough**



The City of Peterborough,  
Planning and Development Services.

# Map No. 24

This map is current to June 2000

**MAP ACCURACY AND INTERPRETATION**

The information depicted on this hardcopy or digital map file is schematic in nature. Accurate interpretation of information shown, should be obtained from appropriate City staff.

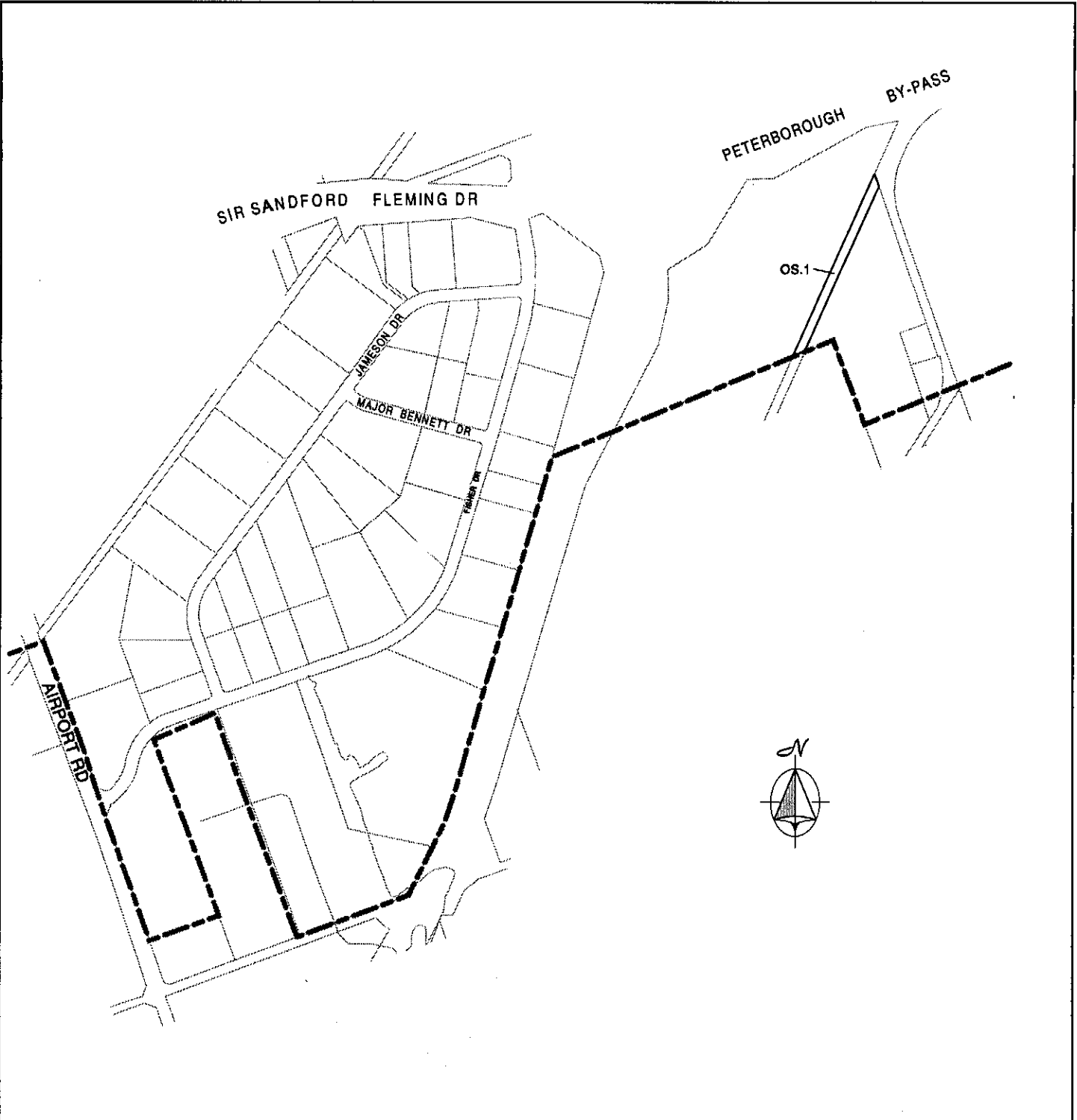

**Details**

--	--



City of Peterborough



The City of Peterborough,  
Planning and Development Services.

**Map No. 25**

This map is current to June 2000

**MAP ACCURACY AND INTERPRETATION**

The information depicted on this hardcopy or digital map file is schematic in nature. Accurate interpretation of information shown, should be obtained from appropriate City staff.

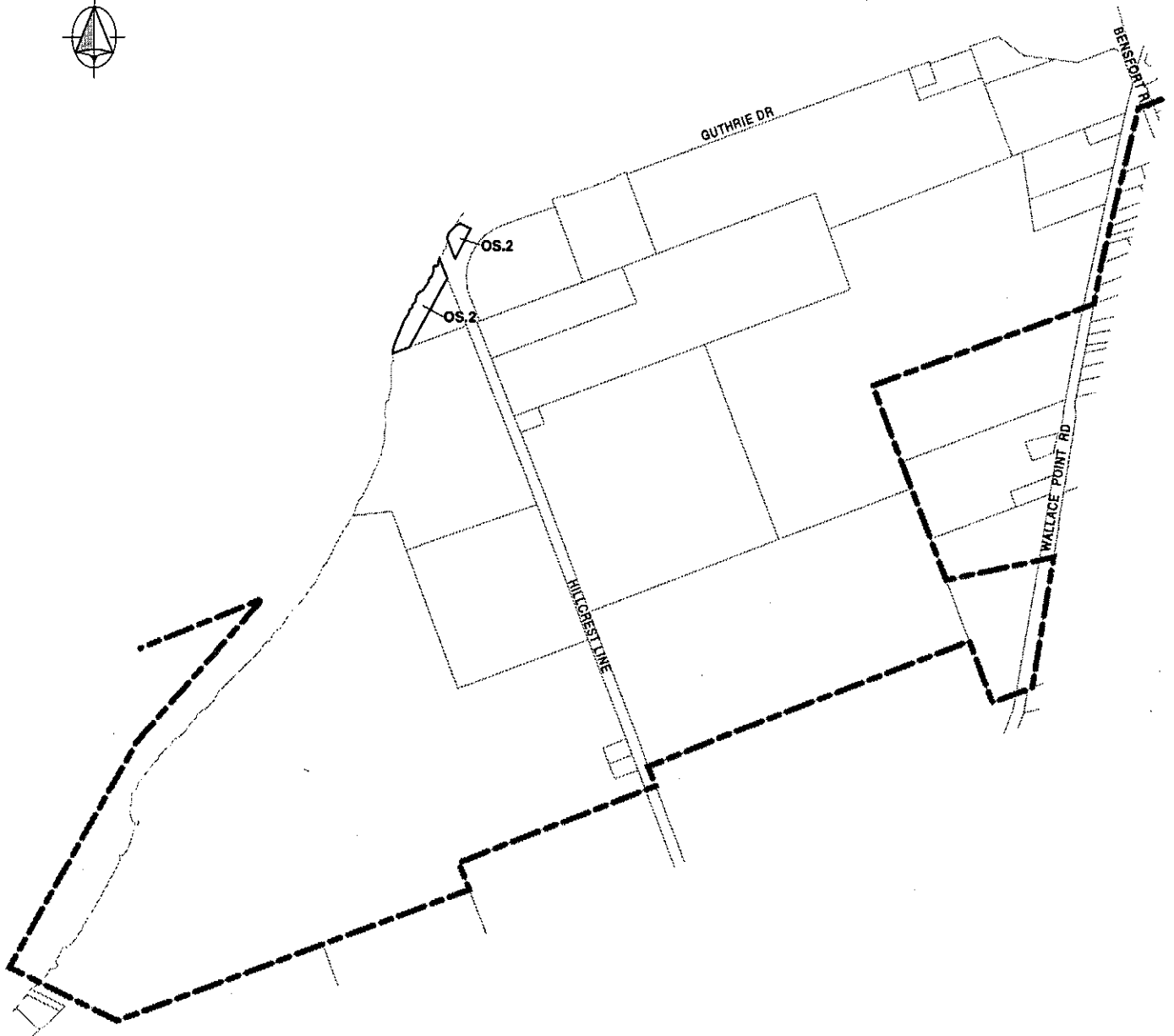
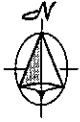

Details



City of  
Peterborough

100 50 0 METRES 125 250

500 0 FEET 500 1000

The City of Peterborough,  
Planning and Development Services.

# Map No. 26

This map is current to June 2000

**MAP ACCURACY AND INTERPRETATION**

The information depicted on this hardcopy or digital map file is schematic in nature.  
Accurate interpretation of information shown, should be obtained from appropriate City staff.