

THE CORPORATION OF THE CITY OF PETERBOROUGH

BY-LAW NUMBER 00-047

**BEING A BY-LAW TO AMEND THE ZONING BY-LAW
FOR**

462 SHERBROOKE STREET

**THE CORPORATION OF THE CITY OF PETERBOROUGH BY THE COUNCIL
THEREOF ENACTS AS FOLLOWS:**

1. Section 3.9 Exceptions of By-law 97-123 is hereby amended by adding the following:

Exception Number
"159"

Provisions
Notwithstanding the provisions of Sections 9 and 10, a boarding house, shall be limited to a maximum of 5 (five) boarders."

2. Section 4.2(A) of By-law 97-123 is hereby amended by adding the following:

Use	Area		
	1	2	3
Boarding House	Minimum of 1 or 1 per 3 boarders, whichever is the greater	Minimum of 1 or 1 per 3 boarders, whichever is the greater	Minimum of 1 or 1 per 2 boarders, whichever is the greater

3. Section 4.3.1 (b) (ii) of By-law 97-123 is hereby amended as follows:
"a maximum of one (1) tandem parking space shall be permitted on a lot in conjunction with each single or two unit dwelling or a boarding house."

4. **Map 11** forming part of Schedule 'A' to By-law 97-123 is amended by changing the area shown on the sketch attached hereto as Schedule 'A' from **R.1, R.2, R.3, R.4, R.5** to **R.1, R.2, R.3, R.4, R.5 - 159**.

By-law read a first and second time this 27th day of March

By-law read a third time and finally passed this 27th day of March

(Sgd.) Sylvia Sutherland, Mayor

(Sgd.) Steven F. Brickell, City Clerk.

Dimensions are in metric



SCHEDULE 'A' TO
BYLAW 2000-047
PASSED THE 22ND DAY
OF March 2000
MAYOR *[Signature]*
CLERK *[Signature]*

Change from
R.1, R.2, R.3, R.4, R.5 to
R.1, R.2, R.3, R.4, R.5-159

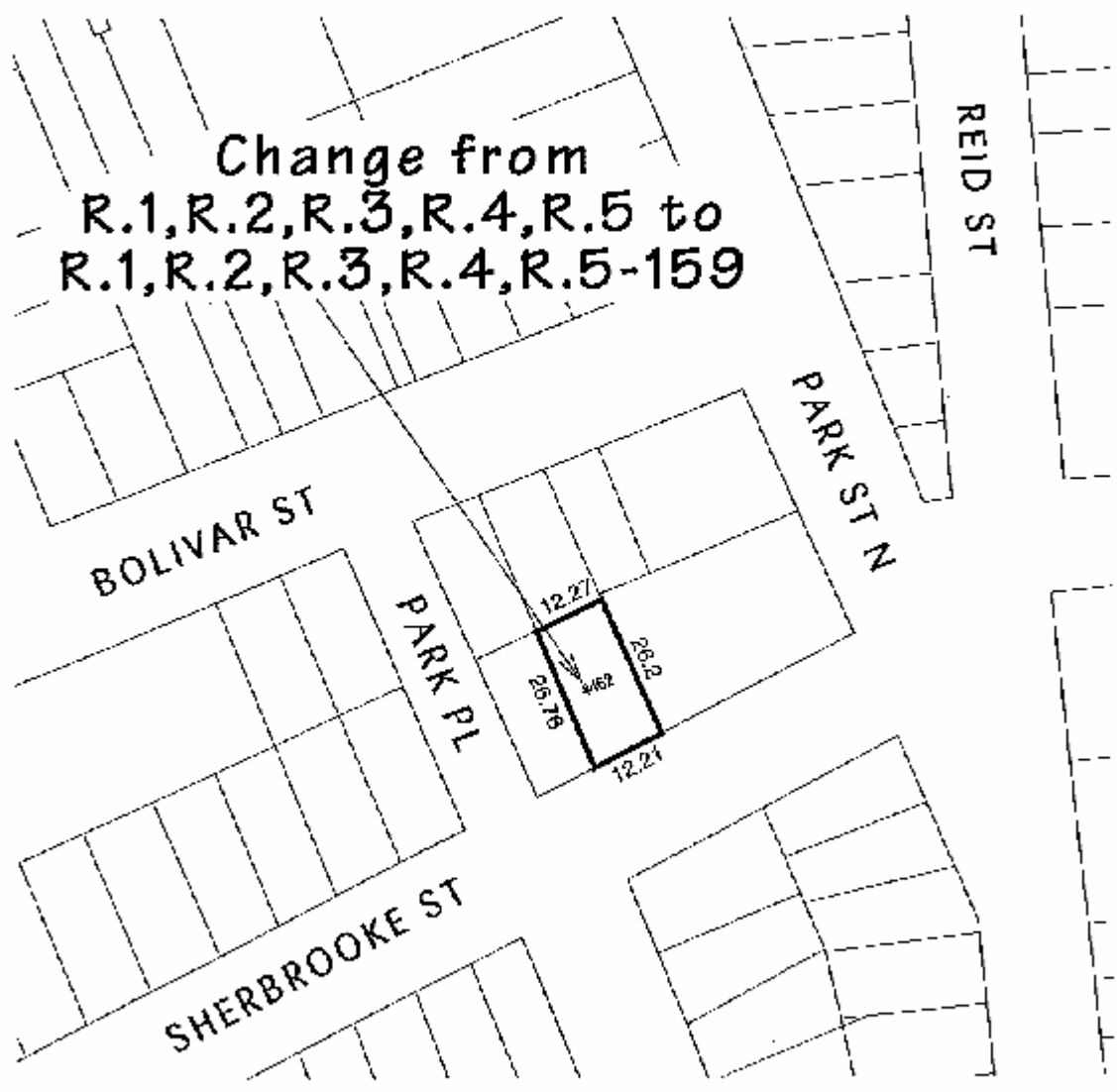

City of
Peterborough

File: 20003

Scale 1: 1000